

RAILKING
READY-TO-RUN™
sets
THE COMPLETE SOLUTION

www.railking.com

0-4-0 Dockside Freight Set

Operation Manual



RAILKING
By MTH Electric Trains

Thank you for purchasing this RailKing product.
PLEASE READ BEFORE USE AND SAVE

Table of Contents

SetUp Checklist.....	3
Getting Started.....	4
Assembling RealTrax®.....	4
Plugging in the Transformer.....	4
Lubricating the Engine.....	5
Priming the Smoke Unite.....	5
Coupling the Engine and Cars.....	5
Basic Operation.....	6
Operation Buttons.....	6
Direction Lock.....	6
Maintenance.....	7
Lubrication and Greasing Instructions.....	7
Cleaning the Wheels, Tires and Track.....	8
ProtoSmoke® Unit Operation.....	8
Locomotive Light Bulb Replacement.....	9
Caboose Light Bulb Replacement.....	9
RailWare Interactive C D R O M.....	10
Troubleshooting.....	11
Compatibility.....	12
Transformer Compatibility Chart.....	12
Exploded View Parts.....	13
Service and Warranty Information.....	16
Authorized Service Centers.....	17

CAUTION: ELECTRICALLY OPERATED PRODUCT:

Not recommended for children under 10 years of age. M.T.H. recommends adult supervision with children ages 10 - 16. As with all electric products, precautions should be observed during handling and use to reduce the risk of electric shock.

WARNING: When using electrical products, basic safety precautions should be observed, including the following: Read this manual thoroughly before using this device.

- M.T.H. recommends that a user and person supervising use examine the hobby transformer and other electronic equipment periodically for conditions that may result in the risk of fire, electric shock, or injury to persons, such as damage to the primary cord, plug blades, housing, output jacks or other parts. In the event such conditions exist, the train set should not be used until properly repaired.
- Do not operate your layout unattended. Obstructed accessories or stalled trains may overheat, resulting in damage to your layout.
- This train set is intended for indoor use. Do not use if water is present. Serious injury or fatality may result.
- Do not operate the hobby transformer with damaged cord, plug, switches, buttons or case.
- The transformer was designed to operate on regular US household current (120 volt, 50-60 Hertz). Do not connect to any other source of power.
- To avoid the risk of electrical shock, do not disassemble the transformer unit. There are no user-serviceable parts inside. If the unit is damaged contact M.T.H. Service for instructions.
- The transformer is equipped with an internal circuit protector. If the circuit protector trips, unplug the power cord from the electrical wall outlet, check your layout for any short circuits. The circuit breaker will reset automatically when the short is removed from the circuit.
- Unplug the transformer from the electrical wall outlet when not in use.
- Do not use this transformer for other than its intended purpose.

Transformer Ratings:

Input: 120VAC
60Hz Only
Output: 18VAC, 3A 54VA

Set Up Checklist

- Assemble RealTrax®
- Connect the transformer
- Lubricate the engine
- Prime the smokeunit
- Place the engine and cars on the track and couple them together
- Apply power to run as described in the Basic Operation section of these instructions.

Set Includes



Steam Engine with Whistle



Gondola Car



8-Pieces
O-31 Curve RealTrax



Box Car



Lighted Work Caboose



Lock-On



Wire Harness



Track Clips



Z-500 Transformer

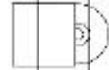

CD-Rom

Tools Needed



Pliers



Scissors



Philips Screwdriver



Cotton Swab or Rag



RailKing Maintenance Kit or
Light Household Oil and Bearing Grease

You can obtain replacement parts and replacement instructions from the M.T.H. Parts Department

e-mail: parts@mth-railking.com

phone: 410-381-2580

mail: 7020 Columbia Gateway Drive, Columbia MD 21046-1532

Getting Started

Assembling RealTrax[®]

The quickconnectors and built-in roadbed allow you to set up RealTrax anywhere, including carpeted surfaces.

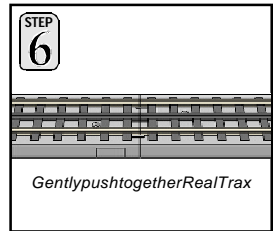
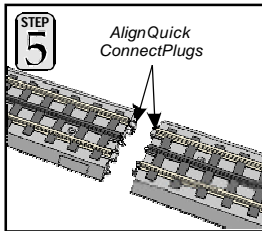
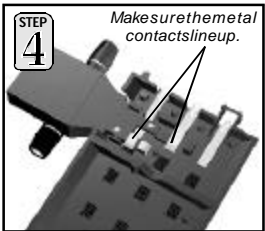
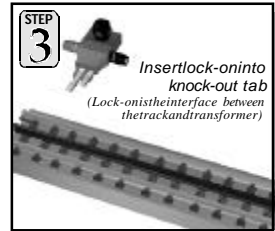
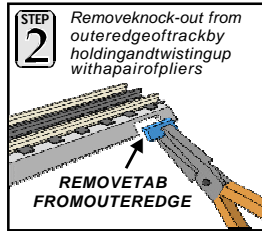
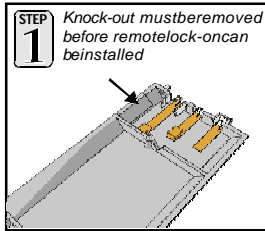

Connecting Track Clips

If you prefer not to screw your track to the table for a permanent layout, use the enclosed track clips on adjoining curved RealTrax sections to secure them in place.

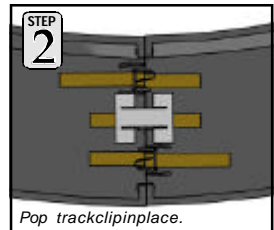
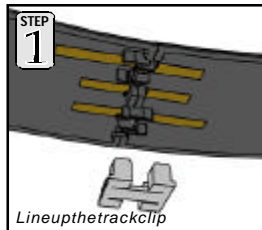

Connecting the Transformer

The Z-500[®] transformer included with this set provides an easy-to-use, safe power source for AC-powered trains and accessories.

To complete the connection between the track and the transformer, simply plug in the color-coded wire harness that was included in your set and plug the transformer into your wall outlet.

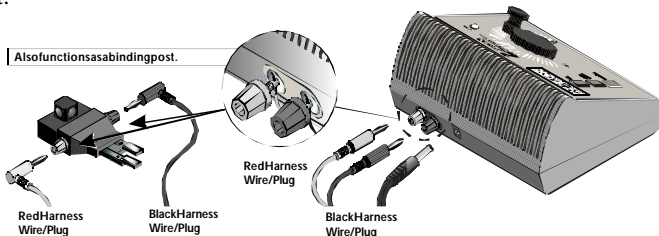

Lubricating the Engine

Lubricate all exposed moving parts before operating using a multi-purpose, plastic-compatible oil (available with M.T.H.'s Maintenance Kit, sold separately) or a light household oil. Follow the lubrication points.

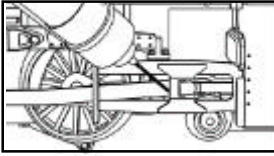

Lubricate Valve Gear

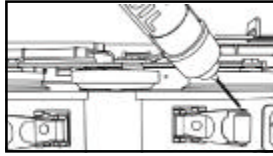

Lubricate Pick-Up Rollers
(Do Not Oil the Flat Part of Pick-Up Rollers)

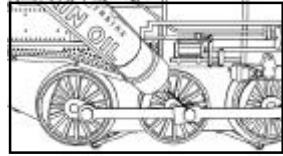

Lubricate Side Rods

Priming the Smoke Unit

You should prime the smoke unit with smoke fluid before operating. Add 15-20 drops of smoke fluid from the included pipette through the smoke stack, then gently blow into the stack to eliminate any air bubbles in the fluid.

If you choose not to prime the unit with fluid, turn the smoke unit switch located under the engine to the OFF position. **Running the engine without a primed smoke unit may cause damage.** See the "Proto Smoke Unit Operation" section of this book for more information on smoke unit maintenance.

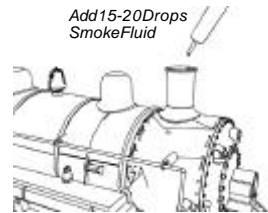

Running the engine without a primed smoke unit may cause damage

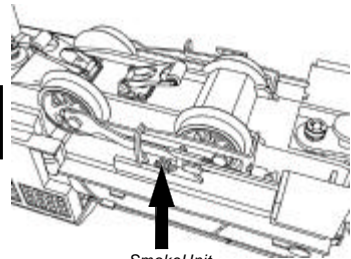

Smoke Unit
ON/OFF Switch

Coupling the Engine and Cars

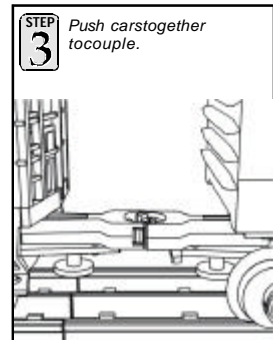
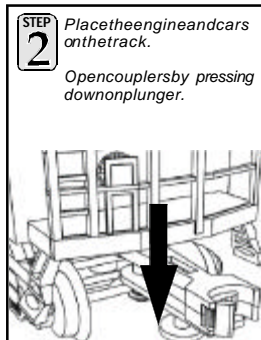
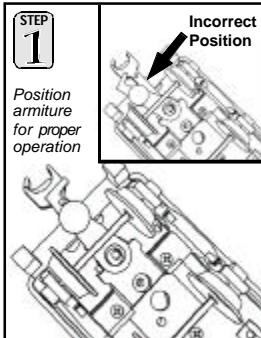

Basic Operation

The Throttle knob controls how fast your train will travel.

- Turn the throttle knob up 1/2-way, until the engine and cabooselights shine bright.
- Put the engine into motion by pressing the Direction button on your transformer once. (hold it for approximately 1 second)

If the engine does not begin to move as soon as you firmly press the Direction button, you may not have sent enough voltage to the track to make the train move. Turn the throttle up a bit higher until the train begins to move.

Operation Buttons

Throttle To increase or decrease track voltage, and therefore train speed, turn the throttle control knob. Turning it clockwise will increase voltage and speed, while turning it counterclockwise will decrease voltage and speed. The engine will maintain the speed you set after you release the throttle until you turn it again to change the voltage and speed.

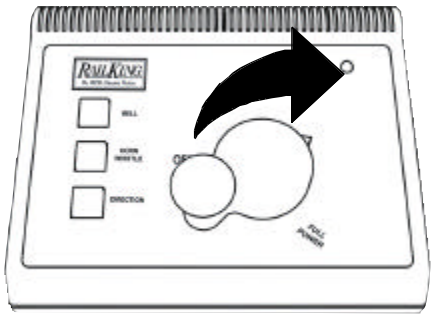

Horn/Whistle - To sound the whistle, firmly press the Horn/Whistle button. The horn will sound for as long as you continue to depress the button. It will stop when you release the button.

Direction Your train is programmed to start in neutral. The train will always cycle neutral-forward-neutral-reverse with each press and release of the direction button. The engine is programmed to restart in neutral each time the track voltage is turned off for 25 seconds or more.

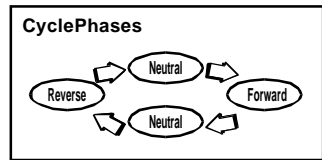

Direction Lock

You can lock your engine into a direction (forward, neutral, or reverse) so that it will not change directions. To do this, put the engine into the direction you want, then remove the engine from the track and slide the ON/OFF switch located on the bottom of the engine to the OFF position. The engine will not change direction (including going into neutral) until you flip the switch back to ON to return the engine to its normal condition, even if the engine is kept without power for extended periods of time.

Maintenance

Lubrication Instructions

The engines should be oiled and greased in order to run properly.



Regularly lubricate all side rods and linkage components and pickup rollers to prevent squeaking. Use light household oil, such as that found in M.T.H.'s maintenance kit. Do not overoil. Use only a drop or two on each pivot point.

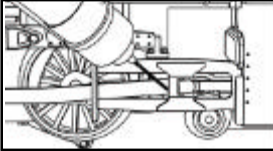

Lubricate Valve Gear

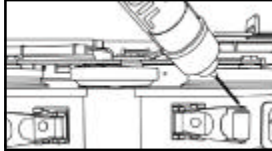

Lubricate Pick-Up Rollers
(Do Not Oil the Flat Part of
the Pick-Up Rollers)

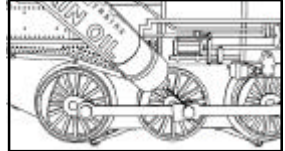

Lubricate Side Rods

Greasing Instructions

Add grease to the internal drive gears (accessed through the gearbox) annually or after every 50 hours of operation. In order to access and put grease into the gear box:

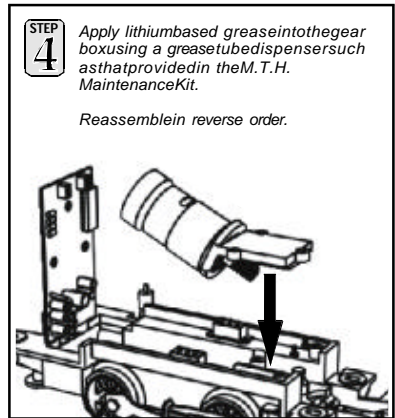
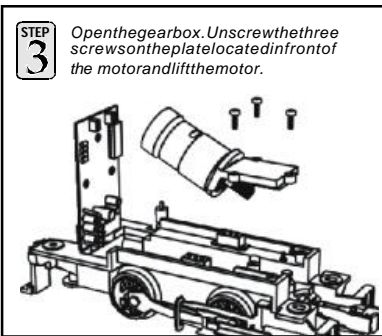
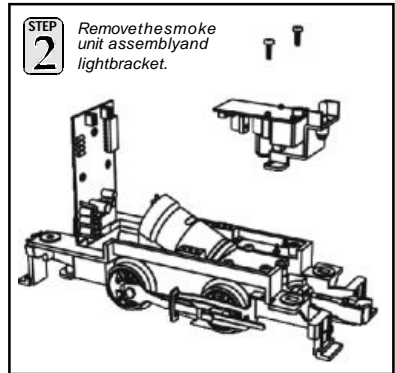
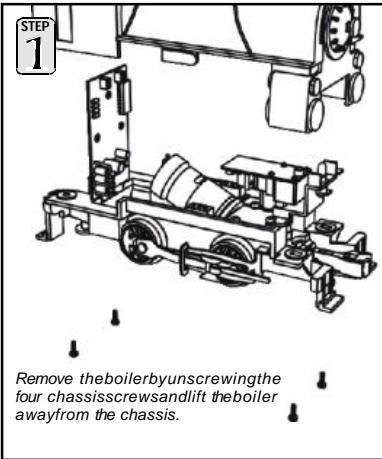

Cleaning the Wheels, Tires and Track

Periodically check the locomotive wheels and pickups for dirt and buildup, which can cause poor electrical contact and traction and prematurely wear out the neoprene traction tires. Wheels and tires can be cleaned using denatured (not rubbing) alcohol applied with a cotton swab.

To clean the track, use RailKing Track Cleaning Fluid and a clean rag or denatured (not rubbing) alcohol. Unplug the transformer and wipe the rails of the track, turning the rag frequently to ensure that you are using a clean cloth on the rails. Because the manufacturing process leaves a coating on Real Trax center rail, you should clean the rails after the first 30 minutes of use (you may notice an electrical smell during initial use as the coating wears off; this is normal). Thereafter, keep an eye on the track and clean it when it gets dirty to ensure good electrical contact and to lengthen the life of the tires.



ProtoSmoke[®] Unit Operation

This steam locomotive contains a smoke unit that outputs smoke through the smoke stack on the boiler of the engine. The smoke unit is essentially a small heating element and wick that soaks up and then heats a mineral oil-based fluid that emits a harmless smoke. The smoke is then forced out of the stack by a small electric fan.

With a few easy maintenance steps, you should enjoy trouble-free smoke unit operation for years.

- When preparing to run this engine, add 15-20 drops of smoke fluid through the smoke stack. We recommend M.T.H. ProtoSmoke, Seuth, LGB, or LVTS fluids (a small pipette of ProtoSmoke fluid is included). Do not overfill the unit or the fluid may leak out and coat the interior engine components.
- If you choose not to add the fluid (or have already added the fluid but choose to run smoke-free), turn off the smoke unit switch located under the engine body. **Failure either to add fluid to the unit or to turn it off may damage the smoke unit heating element and/or wicking material.**

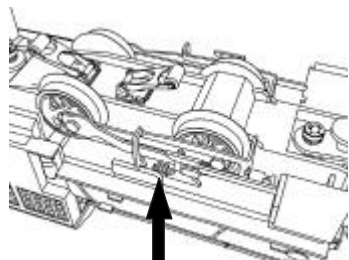
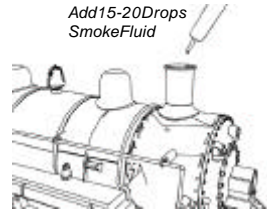

Running the engine without a primed smoke unit may cause damage

- When the smoke output while running the engine begins to diminish, add another 10-15 drops of smoke fluid or turn the smoke unit off.
- When storing the unit for long periods of time, you may want to add about 15 drops of fluid to prevent the wick from drying out.

- After removing the engine from storage, add another 25 drops of fluid, letting the wick soak up the fluid for 15 minutes prior to operation.

If you experience poor or no smoke output when the smoke unit is on and has fluid, check the wick to see if it has become hard, blackened, and unabsorbent around the heating element. Remove the boiler as shown on page 7. Remove the smoke unit inspection cover from the locomotive's body (see right). After removing the chassis and inspection cover screws, lift the inspection plate away and inspect the wick. If it is darkly discolored and hard, it should be replaced. When priming new wick add 40 drops.



Locomotive Light Bulb Replacement

To replace the light bulb in the locomotive, follow the boiler removal instructions on page 7. (Part #CA-0000051)

Once the locomotive boiler has been removed from its chassis, locate the bulb bracket as seen in the illustration on the right and rotate the headlight bulb counter-clockwise to remove.

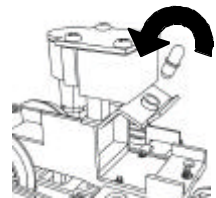

Replace Headlight Bulb

Caboose Light Bulb Replacement

To replace the interior light bulbs follow these instructions and see the diagrams below:

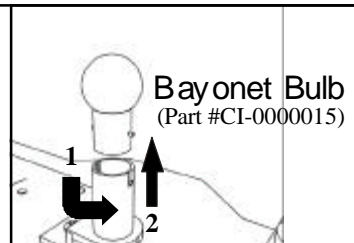
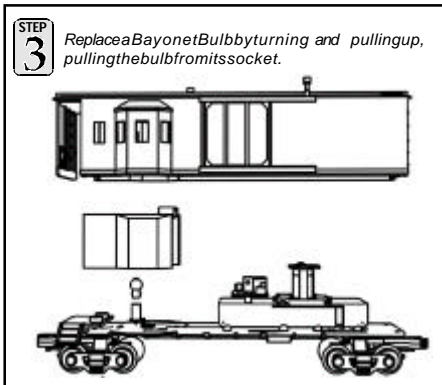
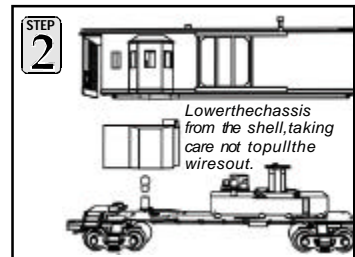
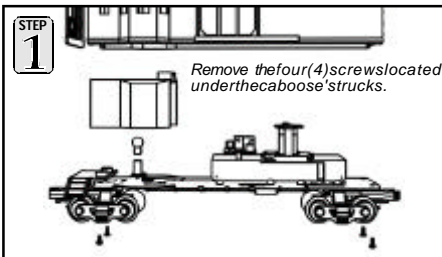

RailWare Interactive CD ROM

M.T.H. provides a free RailWare CD ROM in each Ready-To-Run set. It is full of helpful information on M.T.H. product history, track planning software, a dealer finder, and information and video clips on Loco-Sound and Proto-Sound 2.0. Follow the directions below to use the CD ROM.

Minimum System Requirements: Pentium 100, 16MB RAM, Windows 95 or later, CD ROM drive, SoundCard, display properties set to greater than 256 colors. The CD will not work on a Mac OS unless you run Virtual PC®.

Running RR-Track Software

You may run the RR-Track software directly off of the CD ROM or you may install the software to your hard drive.

1. On the Desktop, click on the icon that says My Computer.
2. Find your CD ROM drive.
3. With the M.T.H. CD ROM in the drive, double click on the icon for the CD ROM drive.
4. Find the folder on the CD ROM entitled INSTALLATION.
5. Choose the folder inside entitled RRTRAXSETUP.
6. Run the file in that folder called SETUP.EXE and follow the directions it provides.

The program may ask you for a registration code. If it does type in "M.T.H." and it will run.

Additional track libraries can be obtained directly from RR-Track. See their website for more information www.rtrack.com.

Installing Adobe Acrobat Software

To read some of the electronic documents included on the CD ROM, you will need to install the Adobe Acrobat Reader® if it is not already on your computer. To install the software:

1. On the Desktop, click on the icon that says My Computer.
2. Find your CD ROM drive.
3. With the M.T.H. CD ROM in the drive, double click on the icon for the CD ROM drive.
4. Find the folder on the CD ROM entitled INSTALLATION.
5. Choose the folder inside entitled ACROBATREADER.

*If you are running Windows 95, 98 or NT choose the folder 32BIT. Run the file AR32E301.EXE and follow the directions it provides.

If you have problems you cannot resolve by using these directions, contact custserv@mth-railking.com or call 410-381-2580 for further help.

Troubleshooting Problems

Although this engine has been designed and engineered for ease of use, you may have some questions during initial operation. The following table should answer most questions. If your problem cannot be resolved with this table, contact M.T.H. for assistance (e-mail: service@mth-railking.com; telephone: 410-381-2580; fax: 410-423-0009; mail: 7020 Columbia Gateway Drive, Columbia MD 21046-1532).

Starting Up	Remedy
When I first turn the power on, the engine will not begin to run. I have to turn the throttle off and then on again to get the engine to operate.	This is normal behavior. To prevent accidental high-speed start-ups, this engine is programmed to start up in neutral any time track power has been turned off for several seconds. See the "Basic Operation" section for more details.
The engine will not start after I press the Direction button.	You may not be sending enough power to the track to power the engine. Press the throttle up a bit higher to increase track power.
Whistle	Remedy
I can't get the Whistle to blow when I press the whistle button.	You may be pressing the button too quickly. Try pressing the whistle button more slowly, taking approximately one full second to fully depress the button.
Bell	Remedy
I can't get the bell to ring when I press the bell button.	This engine is not equipped with a complete sound set, so there is no bell sound. The bell button will have no effect on your engine.
Lock-out	Remedy
I can't get the engine to run after I power up the transformer.	The engine may be locked into the neutral position. Follow the procedure in the "Lock into a Direction" section on page 6 to unlock the engine's direction.

Compatibility

While this Ready-To-Run set is equipped with everything you need to operate it, the design allows flexibility. The train will operate on any traditional O-31 or larger O Gauge track system, including the RealTrax[®] included with this set or traditional tubular track. It is also compatible with most standard AC transformers, including the hobby transformer packaged with your set.

Transformer Compatibility and Wiring Chart

Transformer Model	Center Rail	Outside Rail	Min/Max. Voltage	Power Rating	Transformer Type
Lionel 1032	U	A	5-16v	90-Watt	Standard
Lionel 1032M	U	A	5-16v	90-Watt	Standard
Lionel 1033	U	A	5-16v	90-Watt	Standard
Lionel 1043	U	A	5-16v	90-Watt	Standard
Lionel 1043M	U	A	5-16v	90-Watt	Standard
Lionel 1044	U	A	5-16v	90-Watt	Standard
Lionel 1053	U	A	8-17v	60-Watt	Standard
Lionel 1063	U	A	8-17v	60-Watt	Standard
All-Trol	Left Terminal	Right Terminal	0-24v	300-Watt	Electronic
Cab-1/Powermaster	A	U	0-18v	135V.A.	Electronic
Dallee Hostler	Left Terminal	Right Terminal			Electronic
Lionel LW	A	U	8-18v	75-Watt	Standard
Lionel KW	A or B	U	6-20v	190-Watt	Standard
MRC Tech II	Left Terminal	2 nd From Left	0-15v	40V.A.	Electronic
Lionel MW	Outside Track Terminal	Inside Track Terminal	5-16v	50V.A.	Electronic
R.O.W.	Red Terminal	Black Terminal	0-24v	384-Watt	Standard
Lionel RS-1	Red Terminal	Black Terminal	0-18v	50V.A.	Electronic
Lionel RW	U	A	9-19v	110-Watt	Standard
Lionel SW	U	A	Unknown	130-Watt	Standard
Lionel TW	U	A	8-18v	175-Watt	Standard
Lionel ZW	A, B, C or D	U	8-20v	275-Watt	Standard
Lionel Trainmaster	Red Terminal	Black Terminal	0-18v	135-Watt	Electronic
MTH Z-500	Red Terminal	Black Terminal	0-18v	50-Watt	Electronic
MTH Z-750	Red Terminal	Black Terminal	0-21v	75-Watt	Electronic
MTH Z-4000	Red Terminal	Black Terminal	0-22v	390-Watt	Electronic

Dockside Engine Parts

Name and Number	Part #
1.) Shell (black)(NYC)(# 9998)	FB-1200240
Shell (yellow, red)	FB-1200241
(I Love Toy Trains)(# 1)	
2.) Lens (clear)	FA-1230022
(headlight/reverse light)	
3.) Handrail (nickel)	FB-1200103
4.) Stanchion (black)	FB-1200242
(plastic)(3.0mm long)(NYC)(# 9998)	
Stanchion (yellow)	FB-1200243
(plastic)(3.0mm long)(I Love Toy Trains)(# 1)	
5.) Bell (nickel)	FB-1200101
6.) Name plate (black)(blank)	FB-1200244
(NYC)(# 9998)	
Name plate (red)(# 1)	FB-1200245
(I Love Toy Trains)(# 1)	
7.) Screw	IA-0000050
(6/32x8.0mm)(roundhead)	
8.) Bolt (nickel)	IA-0000265
(M3x10.0mm)(w/ 3.5x4.0mm oversized shank)	
9.) Bolt (nickel)	IA-0000266
(M3x10.0mm)(w/ 2.0x4.0mm oversized shank)	
10.) Drive rod (nickel)	EC-1250018
(56.3mm long)	
11.) Side rod (nickel)	EC-1250019
(55.0mm long)	
12.) Crosshead (nickel)	EC-1250016
13.) Drive rod guide (nickel)(right)	EA-1210007
14.) Drive rod guide (nickel)(left)	EA-1220007
15.) Screw	IA-0000021
(4/40x4.0mm)(roundhead)	
16.) Bulb (clear)(headlight)	CA-0000051
(18v)(long bulb)(small screw base)	
17.) Bracket (black)(metal)	IH-0000088
(for smoke unit/headlight)	
18.) Screw	IA-0000003
(4/40x6.0mm)(roundhead)	
19.) Smoke unit	AA-1200013
20.) Motor mount (black)	BI-0000034
21.) Screw (yellow Zink)	IA-0000089
(M2.5x6.0mm)(roundhead w/ lock washer)	
22.) Screw	IA-0000058
(M2x4.0mm)(roundhead)	
23.) Switch (small)	BB-0000009

24.) Drive block (black) (2 axle)(has screw holes added for part # 43) (NYC)(# 9998) Drive block (2 axle) (light blue drive blockw/ red wheels) (has screw holes added for part # 4 3) (I Love Toy Trains)(# 1)	DF-1200035 DF-1200036
25.) Insulator (black) (top)(square)(pick-up)	BD-0000026
26.) Screw (M3x6.0mm)(roundhead)	IA-0000015
27.) Motor(RS-365SH) (8.0x21.0mm worm gear w/ 13.0mm long threads) (9.0x30.0mm flywheel)	BE-0000045
28.) Board (reverse unit)	AC-0000007
29.) Nut(nickel)(2.2x6.4x2.4mm)	IC-0000010
30.) Screw (4/40x12.0mm)(roundhead)	IA-0000264
31.) Bracket (Aluminum) (reverse unitboard mounting bracket)	IH-0000089
32.) Insulator (clear)(plastic) (box shaped)(17.6x39.8x16.8mm)(0.5mm thick)	BD-0000072
33.) T-bar (black)(plastic)	IG-0000001
34.) Coupler	DD-0000011
35.) Armature	DD-0000012
36.) Spring (6.5x14.0mm)(w/ 0.5mm thick wire)	IE-0000022
37.) Washer (plastic)(black) (cup shapedfor spring tofitin)(4.6x8.6x2.0mm) (inside 7 .0x1.1mm)	ID-0000060
38.) E-clip (3 .0x8.0x0.5mm)	IF-0000002
39.) Nut(2.5x5.0x7.0mm)	IC-0000008
40.) Insulator (black) (pick-up)(bottom)(flat)(square)	BD-0000024
41.) Pick-up (8.0x11.0mm roller)(28.0mmlong)	BD-0000048
42.) Pick-up (8.0x11.0mm roller)(24.0mmlong)	BD-0000050
43.) Bracket (black)(metal) (14.0x42.7x0.5mm)(2.0x21.0mm notch on one side)	IH-0000209

Dockside 0-4-0 Engine Parts

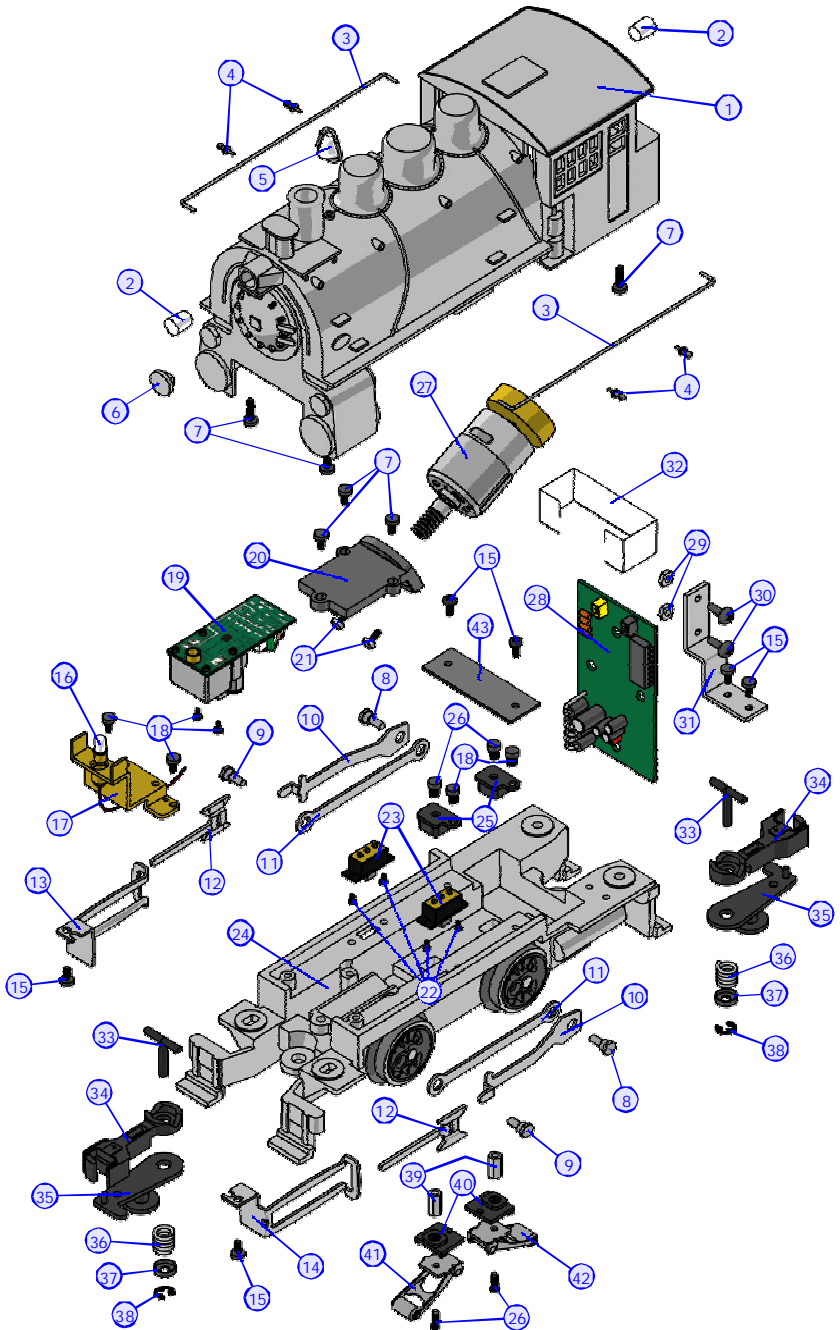

Service & Warranty Information

How to Get Service Under the Terms of the Limited One-Year Warranty

When you suspect an item is defective, please check the operator's manual for standard operation and trouble-shooting techniques that may correct the problem. Additional information may be found on the M.T.H. Website. Should you still require service, follow the instructions below to obtain warranty service.

First, e-mail, write, call or fax M.T.H. Authorized Service Center (ASC) in your area to obtain Repair Authorization. You can find the list of ASCs on the M.T.H. Website, www.mth-railking.com. Authorized Service Centers are required to make warranty repairs on items sold *only* from that store; all other repairs may—or may not—be done at the store's own discretion. If you did not purchase the item directly from the ASC, you will need to select a National Authorized Service Center (NASC). These centers are compensated by M.T.H. to perform warranty service for any customer whose repair qualifies for warranty service. A list of NASC retailers can be located on the M.T.H. Website or by calling 1-888-640-3700. Should the warranty no longer apply, you may choose either an ASC or NASC retailer to service your M.T.H. Product. A reasonable service fee will be charged.

CAUTION: Make sure the product is packed in its original factory packaging including its foam and plastic wrapping material to prevent damage to the merchandise. There is no need to return the entire set if only one of the components is in need of repair unless otherwise instructed by the Service Center. *The shipment must be prepaid and we recommend that it be insured. A cover letter including your name, address, daytime phone number, e-mail address (if available), Return Authorization number (if required by the service center, a copy of your sales receipt and a full description of the problem must be included to facilitate the repairs. Please include the description regardless of whether you discussed the problem with a service technician when contacting the Service Center for your Return Authorization.*

Please make sure you have followed the instructions carefully before returning any merchandise for service. Authorized M.T.H. Service Centers are independently owned and operated and are not agents or representatives of M.T.H. Electric Trains. M.T.H. assumes no responsibility, financial or otherwise, for material left in their possession, or work done, by privately owned M.T.H. Authorized Service Centers.

If you need assistance at any time email MTH Service at service@mth-railking.com or call 410381-2580.

Limited One-Year Warranty

All M.T.H. products purchased from an Authorized M.T.H. Train Merchant are covered by this warranty.

See our website at www.mth-railking.com or call 1-888-640-3700 to identify an Authorized M.T.H. Train Merchant near you.

M.T.H. products are warranted for one year from the date of purchase against defects in material or workmanship, excluding wear items such as light bulbs, pick-up rollers, batteries, smoke unit wicks, and traction tires. We will repair or replace (at our option) the defective part without charge for the parts or labor, if the item is returned to an M.T.H. Authorized Service Center (ASC) or M.T.H. National Authorized Service Center (NASC) within one year of the original date of purchase. This warranty does not cover damages caused by improper care, handling, or use. Transportation costs incurred by the customer are not covered under this warranty.

Items sent for repair must be accompanied by a return authorization number, a description of the problem, and a copy of the original sales receipt from an Authorized M.T.H. Train Merchant, which gives the date of purchase. If you are sending this product to an Authorized Service Center, contact that Center for their return authorization.

This warranty gives you specific legal rights, and you may have other rights that vary from state to state. Specific questions regarding the warranty may be forwarded to M.T.H. directly.

Service Department
M.T.H. Electric Trains
7020 Columbia Gateway Drive
Columbia MD 21046-1532



www.railking.com



AUTHORIZED SERVICE CENTER

7020 Columbia Gateway Dr. - Columbia, MD 21046

Information: 410-381-2580 Fax: 410-381-6122

www.mth-railking.com

PARTICIPATING N.A.S.C. RETAILER LIST

CANADA

TOYTRAIN WORKSHOP
CUMBERLAND
613-833-8331

THETRAINROOM
FERGUS
519-787-3280

CALIFORNIA
TINPLATEJUNCTION
OAKLAND
510-444-4780

COLORADO
MIZELTRAINSINC
WESTMINSTER
303-429-4811

CONNECTICUT
NEW ENGLAND HOBBY
SUPPLY
MANCHESTER
860-646-0610

FLORIDA
ROUNDHOUSE SOUTH
PORT O RANGE
386-304-7002

MARYLAND
PLAZAHOBBY
CUMBERLAND
301-729-6424

ENGINEHOUSEHOBBIES
GATHERSBURG
301-590-0816

CATOCTINMOUNTAINTRAINS
& HOBBIES
THURMONT
301-694-8331

MICHIGAN
MICHIGANMODELTRAIN
CENTER
PINCKNEY
734-426-1651

BRASSEURELECTRIC TRAINS
INC.
SAGINAW
989-793-4753

NEW HAMPSHIRE
TREASUREDTOYS
SALEM
603-898-7224

NEWYORK
AURORA RAILS&HOBBIES
EASTAURORA
716-652-5718

OHIO
DAVISELECTRONICS
MILFORD
513-831-6425

RICK'STOYTRAINS
TOLEDO
419-478-0171

PENNSYLVANIA
BUSSINGERTRAINS
AMBLER
215-628-2366

FAIRCHANCEPHARMACY
FAIRCHANCE
724-564-7817

TOBY TYLER'S HOBBY
CENTER
PITTSBURGH
412-653-5030

VIRGINIA
LOCUST GROVE TRAINS
LOCUST GROVE
540-854-8955

DAVISHOBBYSUPPLIES
PORTSMOUTH
757-397-1983

T S G HOBBIES
WARRENTON
540-347-9212

WISCONSIN
SOMMERFELD'S TRAINS
BUTLER
262-783-7797

GRAMPA'S TRAINSHOP
RICE LAKE
715-234-2996



ELECTRIC TRAINS[®]

AUTHORIZED SERVICE CENTER

7020 Columbia Gateway Dr. - Columbia, MD 21046

Information: 410-381-2580 Fax: 410-381-6122

www.mth-railking.com

PARTICIPATING A.S.C. RETAILER LIST

CANADA

TOYTRAIN WORKSHOP
CUMBERLAND
613-833-8331

THETRAINROOM
ERGUS
519-787-3280

CREDITVALLEYRAILWAY
COMPANY
STREETSVILLE
905-826-1306

BHTRAINS
TERREBONNE
450-492-0317

ALABAMA
SOUTHERLAND STATION
HUNTSVILLE
256-533-4720

LIL' BOBBY'SHOBBIES
MONTGOMERY
334-277-1715

ARIZONA
ARIZONATRAIN DEPOT
MESA
480-833-9486

CALIFORNIA
CENTRALCOAST TRAINS
ATASCADERO
805-466-1391

TRAIN SHACK
BURBANK
818-842-3330

ROUNDHOUSE
NORTH HOLLYWOOD
818-769-0403

DOLLHOUSES TRAINS & MORE
NOVATO
415-883-0388

TINPLATEJUNCTION
OAKLAND
510-444-4780

RON'SWORLD
SANCLEMENTE
949-361-5596

TRUCKS&TRAINSHOBBIES
SANTAROSA
707-537-6586

COLORADO
CUSTOM RAILWAYSUPPLY
COLORADOSPRINGS
719-634-4616

CABOOSEHOBBIES
DENVER
303-777-6766

MIZELLTRAINS
WESTMINSTER
303-429-4811

CONNECTICUT
NEWENGLANDHOBBY
SUPPLY

MANCHESTER
860-646-0610

FLORIDA
HOLLYWOOD STATION
HOLLYWOOD
954-921-2700

DEPOTHOBBYSHOP
LAKEWORTH
561-585-1982

READYTOROLL
MIAMI
305-688-8868

FRANK'STRAINS&HOBBIES
OLDSMAR
813-855-1041

COLONIAL PHOTO&HOBBY
ORLANDO
407-841-1485

WARRICK CUSTOM HOBBIES
PLANTATION
954-370-0708

ROUNDHOUSE SOUTH
PORT ORANGE
386-304-7002

ILLINOIS
BIKE&CHOOCHOO
CONNECTION
SCHAUMBURG
847-882-7728

INDIANA
Y.O.R.K.TRAINS
MUNSTER
219-838-9999

SAMUELSON'STRAINSHOP
VALPARAISO
219-462-2708

IOWA
CABOOSSESTOPHOBBIES
CEDARFALLS
800-642-7012

KENTUCKY
L&NTRAINS&THINGS
LOUISVILLE
502-897-9005

LOUISIANA
AMERICA'STRAINYARD
BATONROUGE
225-926-5592

MAINE

WHEELS, WINGS & THINGS
LUDLOW
207-532-6277
MARYLAND
PLAZA HOBBY
CUMBERLAND
301-729-6424

HOBBYTOWN S A
FREDERICK
301-694-7395

ENGINE HOUSE HOBBIES
GAITHERSBURG
301-590-0816

J & B TRAINS
HAGERSTOWN
240-420-4930

THE TRAIN ROOM
HAGERSTOWN
301-745-6681

PURKEY'S TOY TRAINS
SYKESVILLE
410-549-6061

CAT OCTIN MOUNTAIN TRAINS
& HOBBIES
THURMONT
301-694-8331

MASSACHUSETTS

NORTHEAST TRAINS
PEABODY
978-532-1615

EAST BAY HOBBIES
SEEKONK
508-336-5573

MICHIGAN

MICHIGAN MODEL TRAIN
CENTER
PINCKNEY
734-426-1651

BRASSEUR ELECTRIC TRAINS
INC.
SAGINAW
989-793-4753

MISSOURI

SWITCH STAND
SAINT LOUIS
314-781-4458

MARK TWAIN HOBBY CENTER
ST. LOUIS
636-946-2816

NEVADA

RENO RAILS
RENO
775-337-6669

NEW HAMPSHIRE

RAILROAD SPECIALTIES
NASHUA
603-801-0801

TREASURED TOYS

SALEM
603-898-7224

NEW JERSEY

COUNTRY AND STUFF
ANDOVER
973-786-7086

COLUMBUSTRAINSTATION

COLUMBUS
609-518-1800

ATLANTIC RAILS
HAMMONTON
609-567-8490

GRAND CENTRAL STATION
KEARNY
201-955-6200

J & B TRAINS, INC.
MAPLESHADE
856-414-0092

HOBBY SHOP
MATAWAN
732-583-0505

HOBBYMASTERS, INC
RED BANK
732-842-6020

RIDGEFIELD HOBBY
RIDGEFIELD
201-943-2636

TOM'S MODEL TRAINS
SCOTCH PLAINS
908-322-6122

TRAINS & THINGS
TRENTON
609-883-8790

COAST TRAINS AND
COLLECTIBLES
WALL
732-556-9005

HOLLY BEACH TRAIN DEPOT
WILDWOOD
609-522-2379

NEW YORK

AURORA RAILS & HOBBIES
EAST AURORA
716-652-5718

NASSAU HOBBY CENTER, INC.
FREEPORT
516-378-9594

HOBBY WORLD
MONTICELLO
845-794-8770

CITY DEPOT, INC.
NEW HAMPTON
845-374-3010

SCAG'S ELECTRIC TRAINS
STATEN ISLAND
718-727-7373

AMERICAN STORE

TIVOLI
845-757-4246

KROSS HARDWARE
WEST B ABYLON
631-669-3069

NORTH CAROLINA

THE ROUNDHOUSE &
BACKSHOP
CARY
919-465-0810

TRAIN SLTD.
CHARLOTTE
704-566-9070

DRY BRIDGE STATION
MOUNTAERY
336-786-9811

THE FREIGHT YARD
SMITHFIELD
919-934-6229

TRAIN LOFT
WINSTON-SALEM
336-760-9817

OHIO

GLEN'S TRAIN SHOP
AKRON
330-253-6527

E & S TRAINS
AKRON
330-745-0785

T & K HOBBY SHOP
BRIDGEPORT
740-633-6607

PARMA HOBBY
CLEVELAND
216-741-6440

SANDY'S HOBBY'S &
COLLECTIBLES
ELYRIA
440-365-9999

HUDSON TOY, TRAIN &
HOBBY
HUDSON
330-653-2997

CLEARVIEW TRAIN & HOBBY
LORAIN
440-277-4488

DIXIE UNION STATION
MASON
513-459-0460

DAVIS ELECTRONICS
MILFORD
513-831-6425

TRAINS-N-THINGS
NORTH CANTON
330-499-1666

GRAND PACIFIC JUNCTION
OLMSTEAD FALLS
440-235-4777

RICK'S TOY TRAINS
TOLEDO
419-478-0171

ERIE RAILWAY DEPOT
TROY
937-440-9972

PENNSYLVANIA
AMERICAN HOBBY CENTER
ALIQUIPPA
724-378-3930

ALLEN TOWN TOY TRAIN
SERVICE
ALLEN TOWN
610-821-0740

ON THE RIGHT TRACK
ALTOONA
814-942-4345

BUSSINGER TRAINS
AMBLER
215-628-2366

JIM'S HOBBY SERVICE
BERWICK
570-759-2695

YE OLDE TRAIN & CHRISTMAS
SHOPPE
BOYERTOWN
610-369-0755

NICHOLAS SMITH
BROOMALL
610-353-8585

CHARLEROI SWEEPER
CENTER
CHARLEROI
724-483-3397

CRANBERRY HOBBY DEPOT
CRANBERRY TWP
724-776-3640

FAIR CHANCE PHARMACY
FAIR CHANCE
724-564-7817

TOY TRAIN STATION
FEASTERVILLE TREV
215-322-5182

THE CABOOSE
LE HIGHTON
570-386-5352

HOBBY CITY
MCMURRAY
724-942-2557

THE STATION
NEW CUMBERLAND
717-774-7096

FRYER'S STORE
ORWIGSBURG
570-366-2258

CHESTNUT TOY BOX
PHILADELPHIA
215-545-0455

TOBY TYLER'S HOBBY
CENTER
PITTSBURGH
412-653-5030

WILCOX GREENHOUSE &
NURSERY
TITUSVILLE
814-827-3823

EASTERN DEPOT
TROY
570-297-1975

J&R RAILROAD CROSSING
TURTLE CREEK
412-824-6009

TRAINS R FUN
LEESBURG
703-779-8600

SOUTH CAROLINA
EMERALD TRAIN & HOBBY
GREENWOOD
864-223-2247

TENNESSEE
MODEL RAILROAD & HOBBY
SHOP
MEMPHIS
901-384-6500

TEXAS
HOBBY TIME
AMARILLO
806-352-9660

RIVERVIEW TRAINS
ANGLETON
979-848-3895

GREAT TRAINS & HOBBIES
LONGVIEW
903-757-2720

VIRGINIA
LEESBURGH HOBBIES
LEESBURG
703-779-8600

LOCUST GROVE TRAINS
LOCUST GROVE
540-854-8955

TRAIN DEPOT
MANASSAS
703-335-2216

CHESTERFIELD HOBBIES
MIDLOTHIAN
804-379-9091

DAVIS HOBBY SUPPLIES
PORTSMOUTH
757-397-1983

TOY TRAIN CENTER
RICHMOND
804-288-4475

NUTBUSH EXPRESS
VICTORIA
434-696-1902

T S G H HOBBIES
WARRENTON
540-347-9212

NORGE STATION
WILLIAMSBURG
757-564-7623

WASHINGTON
EASTSIDE TRAINS
KIRKLAND
425-828-4098

WEST VIRGINIA
PATRICK'S TRAINS
WHEELING
304-232-0714

WISCONSIN
WOODCRAFTERS SHOP
BURLINGTON
262-763-5239

SOMMERFELD'S TRAINS
BUTLER
262-783-7797

HOBBY OUTLET
FOND DULAC
920-924-3770

G B T V & TRAINS
GREEN BAY
920-496-9697

GRAMPA'S TRAIN SHOP
RICELAKE
715-234-2996

THE TRAIN STORE
WAUKESHA
262-650-6675