

## How to Get Service Under the Terms of the Limited One-Year Warranty

For warranty repair, do not return your product to the place of purchase. Instead, follow the instructions below to obtain warranty service, as our dealer network is not prepared to service the product under the terms of this warranty.

1. First, write, call or FAX M.T.H. Electric Trains, 7020 Columbia Gateway Drive, Columbia, MD 21046, (Tel: 410-381-2580; FAX : 410-423-0009; e-mail: [service@nth-railking.com](mailto:service@nth-railking.com)), stating when it was purchased and what seems to be the problem. You will be given a return authorization number to assure that your merchandise will be properly handled upon its receipt.
2. CAUTION: Make sure the product is packed in its original factory packaging including its foam and plastic wrapping material so as to prevent damage to the merchandise. The shipment must be prepaid and we recommend that it be insured. ***A cover letter including your name, address, daytime phone number, e-mail address (if available), Return Authorization number, a copy of your sales receipt and a full description of the problem must be included to facilitate the repairs. Please include the description regardless of whether you discussed the problem with one of our service technicians when contacting M.T.H. for your Return Authorization number.***
3. Please make sure you have followed the instructions carefully before returning any merchandise for service.

### Limited One-Year Warranty

**All M.T.H. products purchased from an Authorized M.T.H. Train Merchant are covered by this warranty.**

See our website at [www.mth-railking.com](http://www.mth-railking.com) or call 1-888-640-3700 to identify an Authorized M.T.H. Train Merchant near you.

M.T.H. products are warranted for one year from the date of purchase against defects in material or workmanship, excluding light bulbs and traction tires. We will repair or replace (at our option) the defective part without charge for the parts or labor, if the item is returned to M.T.H. Electric Trains within one year of the original date of purchase. This warranty does not cover damages caused by improper care, handling, or use. Transportation costs incurred by the customer are not covered under this warranty.

Items sent for repair must be accompanied by a return authorization number, a description of the problem, and the **original sales receipt from an Authorized M.T.H. Train Merchant**, which gives the date of purchase. Call 410-381-2580, fax 410-423-0009, or e-mail the Service Department at [service@nth-railking.com](mailto:service@nth-railking.com) to obtain a return authorization number.

This warranty gives you specific legal rights, and you may have other rights that vary from state to state.

Service Department  
M.T.H. Electric Trains  
7020 Columbia Gateway Drive  
Columbia MD 21046-1532

**RAIL KING**  
By M.T.H. Electric Trains

**M.T.H.**  
ELECTRIC TRAINS, INC.

7020 Columbia Gateway Drive  
Columbia, MD 21046-1532

[www.mth-railking.com](http://www.mth-railking.com)

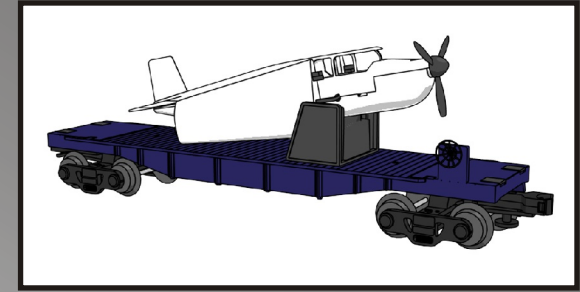

The Flat Car with Plane adds more excitement and fun to your layout. Constructed from sturdy ABS plastic and brightly painted, the Flat car and plane make a perfect addition to any O-27 or O Gauge layout.

Both the Flat car and plane are pre-assembled, so there is no setup. Operation is made easy by following the diagram on the inside.

**FLAT CAR**  
WITH AIRPLANE

## OPERATING INSTRUCTIONS

.To get the plane into flight position, Release the elastic securing the plane to the car by reaching under the flat car and slipping the aglet through the hole in the car. Fold out and turn the wing so that it is perpendicular to the side of the plane, in flight position (figure 1). Lock the wing into place by pressing down and in until the plastic tabs snap securely into the holes in the sides of the plane (figures 2 and 3). Pull out the landing gear under the wings (figure 4)

.To set up the plane for transport, Retract the landing gear by folding it under the wing (figure 5). Gently pull the wing straight out until the tabs release and only the joint holds the wing to the plane. Fold the wings back beside the body, then place the plane on the flat car, aligning it so that the opening in the bottom of the plane fits into the base (figure 6a). Lock the plane into place by sliding the aglet back through the hole in the flat car and securing it there (figure 6b)

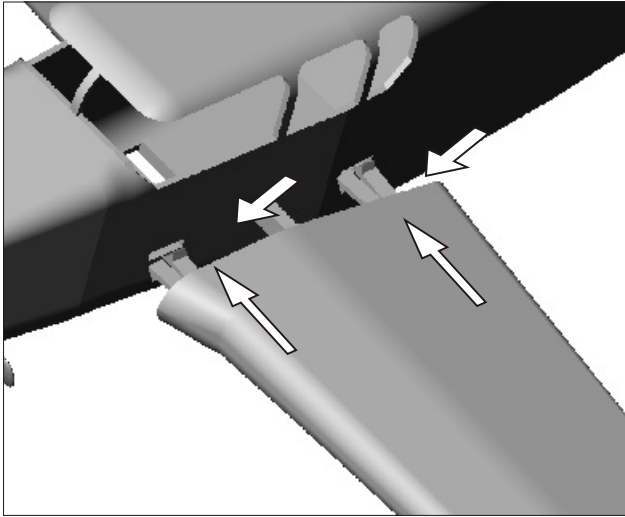

FIGURE 1

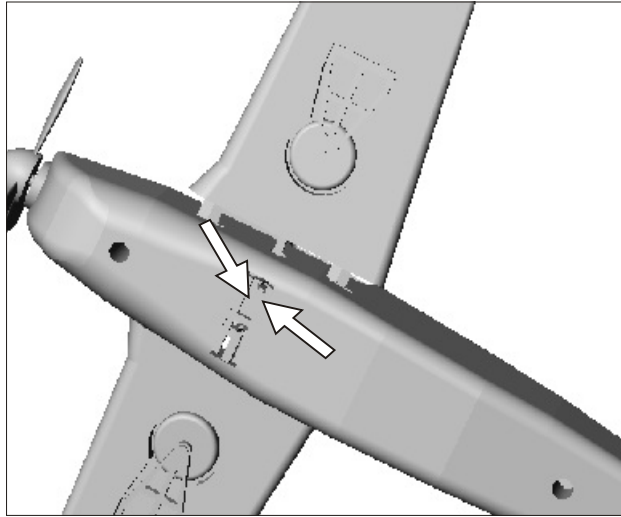

FIGURE 2

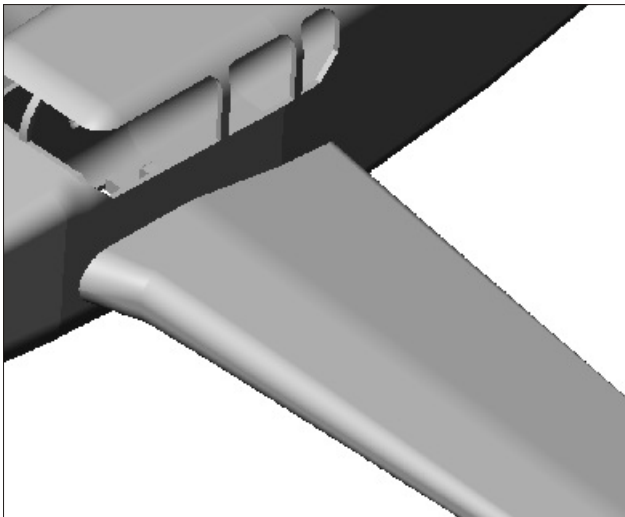

FIGURE 3

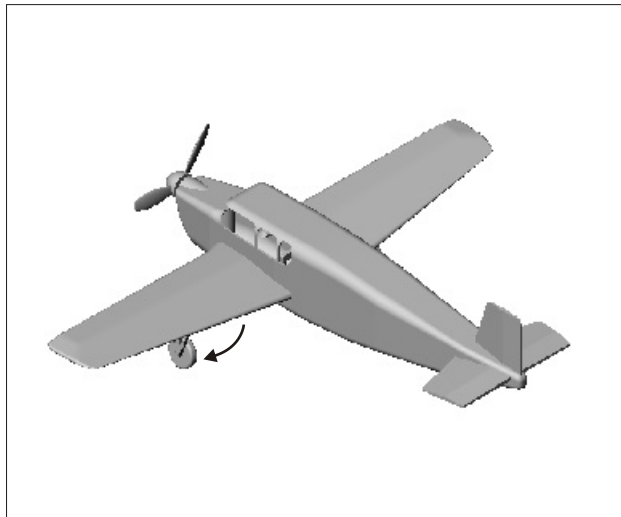

FIGURE 4

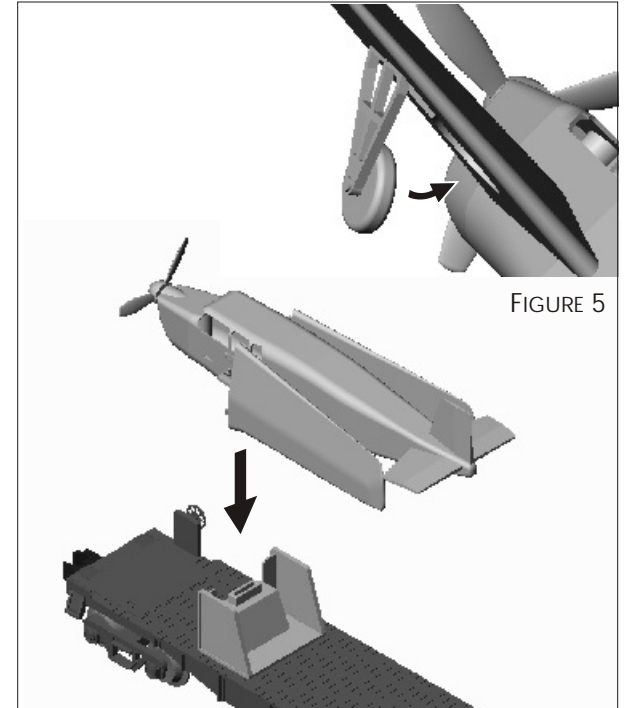

FIGURE 6A

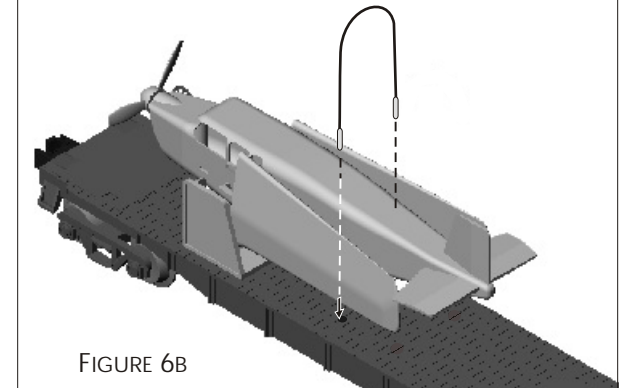

FIGURE 6B