



# RAILKING F59PH DIESEL ENGINE OPERATING INSTRUCTIONS



This RailKing F59PH set boasts a detailed ABS body and operates on O-31 track. This RailKing Diesel Engine contains M.T.H.'s Loco-Sound™ sound and train control system. The locomotive is easy to operate with any compatible standard AC transformer (see the compatibility chart on page 14), and is completely compatible with most other 3-rail locomotives, rolling stock, and accessories.

Please read all the accompanying instructions carefully before setting up and operating your locomotive.



## Table of Contents

<b>Initial Lubrication</b>	3
<b>Basic Operation</b>	4
Throttle	4
Operation Buttons	4
Speed Control	5
Direction Lock	5
Proto-Cast and Proto-Dispatch	6
Volume Control	7
<b>Maintenance</b>	8
Lubrication and Greasing Instructions	8
Cleaning the Wheels, Tires and Track	9
Locomotive Traction Tire Replacement	10
Locomotive Light Bulb Replacement	11
<b>Troubleshooting</b>	12
<b>Compatibility</b>	13
<b>Transformer Compatibility Chart</b>	14
<b>Safety Precautions</b>	15
<b>Service and Warranty Information</b>	16

## **Initial Lubrication**

Although the engine was lubricated at the factory, it is important that you lubricate the chassis before operation. Lightly grease the outside idler and drive gears (marked “G” in Fig. 3 on page 9) to prevent them from squeaking. Use light household oil and follow the lubrication points marked “L” in Fig. 2 on page 8. Do not over-oil. Use only a drop or two on each pivot point.

At this point, you are ready to put your engine on the track and begin running it.

# Basic Operation

**Throttle** – Throttle up the power to your track. Give enough power so that the engine's headlight shines brightly. Then put the engine into motion by either firmly pressing the Direction button on your transformer or remote once or dropping and advancing the throttle to put the engine in forward.

## Operation Buttons

Use the operation buttons on your transformer as described below.

**Horn/Whistle** - To sound the horn, firmly press the Horn/Whistle button. The whistle will sound for as long as you continue to depress the button. It will stop when you release the button. The whistle has four different endings, depending on whether you hold the button for less than three seconds, three seconds, four seconds, or five seconds or longer.

**Bell** - To sound the bell, firmly press and release the Bell button. To turn the bell off, press and release the Bell button again. The bell will continue to ring from the time you turn it on until you press and release the button again to turn it off.

**Direction** – Your train is programmed to start in neutral. To put the engine into forward and then to change the direction of the train or to put it into neutral, firmly press and release the Direction button on your transformer. Just as you must stop your car between forward and reverse, this engine will not go directly from forward to reverse; it goes into neutral between directions. If the train has been moving forward, the first press of the Direction button will put the train from forward into neutral, the second press into reverse, the third press back into neutral, and the fourth back into forward. To prevent accidental high-speed start-ups, this engine is programmed to restart in neutral each time the track voltage is turned off for 10 seconds or more.

## Speed Control:

M.T.H. engines equipped with Loco-Sound have speed control capabilities that allow the engine to maintain a constant speed up and down grades and around curves, much like an automobile cruise control. You can add or drop cars on the run, and the engine will maintain the speed you set.

While the engine is programmed to start with the speed control feature activated, you can opt to turn it off. This means the engine's speed will fall as it labors up a hill and increase as it travels downward. It is also affected by the addition or releasing of cars while on the run.

**To turn speed control on and off**, put the engine in neutral, then press the transformer's Whistle button firmly but quickly one time then immediately press the Bell button two times. Repeat the 1 whistle, 2 bells code to return it to the other state. **You will want to do this during the initial neutral upon start-up if you ever couple this engine to another engine that is not equipped with speed control to avoid damaging the motors in either engine.** Each time you shut down the engine completely, it will automatically turn speed control on.

## Direction Lock:

You can lock your engine into a directional state (forward, neutral, or reverse) so that it will not change directions. To do this, put the engine into the direction you want or into neutral, to lock it into neutral, run it at a very slow speed (< 10 scale mph), and quickly but firmly press your transformer's Whistle button once followed immediately by three presses of the Bell button. The engine will not change direction (including going into neutral) until you repeat the 1 whistle, 3 bells code to return the engine to its normal state.

Feature to Be Activated:	Button Code:
Speed Control On/Off	1 Whistle, 2 Bells
Lock into a Direction/Unlock	1 Whistle, 3 Bells

## **Proto-Cast and Proto-Dispatch:**

When used with the RailKing Remote Lock-on™ (sold separately), Loco-Sound-equipped engines gain Proto-Cast™ and Proto-Dispatch™ features.

**Proto-Cast:** This feature allows you to play audio recordings through your engine's speakers. You must supply the audio source (a small portable is sufficient) and a male-to-male mini cable (1/8" plug, like that used for the headset with a portable CD/tape player) to connect your audio source to the remote lock-on. To use Proto-Cast, simply plug the mini-cable into your audio source (usually into the headphone jack) and into the "Audio" port on the right side of the remote lock-on and adjust the volume.

**Proto-Dispatch:** This feature allows you to broadcast your own voice through your engine's speakers. You must supply the microphone and a mini cable (1/8" plug, like that used for the headset with a portable CD/tape player) to connect your microphone to the remote lock-on. To use Proto-Dispatch, simply plug the mini-cable into the microphone and into the "Mic" port on the left side of the remote lock-on and speak into the microphone.

When these features are in use, the locomotive's own sounds (engine sounds and bells, whistles, and horns) will be muted so that only the sounds you broadcast will be heard. Because these two features are voice activated, there will be a 10-15 second delay after you stop speaking into the microphone or turn off the audio source before the engine sounds resume. To stop using the feature and return to normal operation, unplug the cable from the lock-on jack.

If using parallel tracks with multiple Loco-Sound-equipped engines, Proto-Cast and Proto-Dispatch transmissions from one track may be picked up by the other nearby engines.

If you experience popping and interference, try cleaning the track with denatured alcohol as described in the "Cleaning the Wheels, Tires and Track" section of this booklet.

**Note: M.T.H. does not recommend using Proto-Cast and Proto-Dispatch at the same time.**

**Manual Volume Control** – To adjust the volume of all sounds made by this engine, turn the master volume control knob located under the tender clockwise to increase the volume and counter-clockwise to decrease the volume (see Fig. 1).

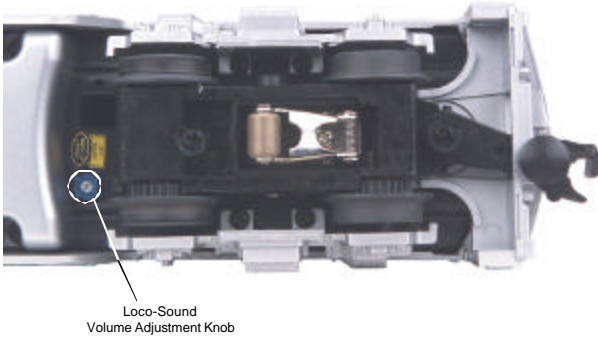

*Figure 1. Location of the Loco-Sound Volume Adjustment Knob*

# Maintenance:

## Lubrication and Greasing Instructions

The engine should be oiled and greased in order to run properly.

You should regularly lubricate all outside idler gears and pickup rollers to prevent them from squeaking. Use light household oil and follow the lubrication points marked “L” in Fig. 2. Do not over oil. Use only a drop or two on each pivot point.

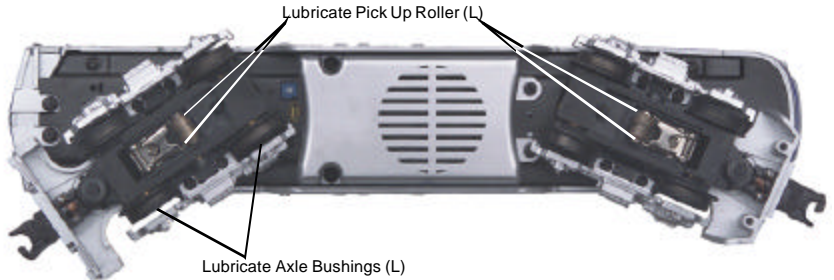

*Figure 2. Lubrication Points on the Engine*

The locomotive’s internal gearing was greased at the factory and should not need additional grease until after 50 hours of operation or one year, whichever comes first. Use lithium based grease and follow the greasing instructions below. Note that in some tightly packed engines you may need to move internal components temporarily in order to access the gears.

1. Remove the Phillips screws from the chassis, as seen in Figure 3, then lift the body away from the chassis.
2. Remove the truck blocks from the chassis by unscrewing the black Phillips motor mount screw on the bottom of each truck block, as shown in Figure 3.
3. Once the motor mount screw has been removed, pull the motor away from the truck block and lightly coat the motor worm gear and bronze drive gear (in the truck block) with grease (See Figure 3a).
4. Reassemble the truck and motor, being careful not to pinch any wires between the truck block and motor mount.



5. Repeat the procedure for the other motor and truck

6. Reassemble the chassis and body, being careful that the wires are not caught between the body and chassis, as this can lead to a short that may damage the electronics beyond repair.

It is also a good idea to lubricate the outside truck block idler and drive gears with grease occasionally. Add grease to the points marked with “G” in Figure 3.

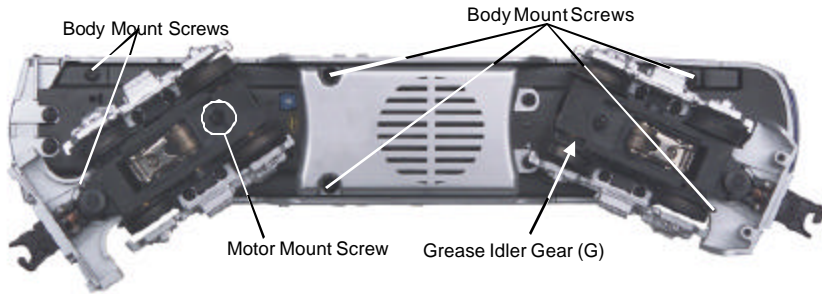

*Figure 3. Body Mount Screws and Greasing Points.*

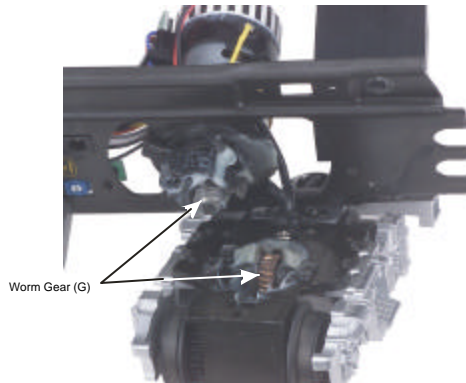

*Figure 3a. Grease the Worm Gear*

## Cleaning the Wheels, Tires and Track

Periodically check the locomotive wheels and pickups for dirt and buildup, which can cause poor electrical contact and traction as well as prematurely wear out the neoprene traction tires. Wheels and tires can be cleaned using denatured alcohol (not rubbing alcohol), which can be found in home improvement stores, applied with a cotton swab.

Occasional cleaning of the track will also help to ensure good electrical contact and to prolong the life of your engine's tires. To clean the track, use a clean rag and denatured alcohol (not rubbing alcohol). Unplug the transformer and wipe the rails of the track, turning the rag frequently to ensure that you are using clean cloth on the rails.

## Traction Tire Replacement Instructions

Your locomotive is equipped with two neoprene rubber traction tires on each powered truck block. While these tires are extremely durable, you may need to replace them at some point.

First, remove the truck sides from the truck block. To do this, turn your engine upside down. If there are visible Phillips screw heads between the truck frame and truck block (see Fig. 4), go to step A. If not, go to step B.

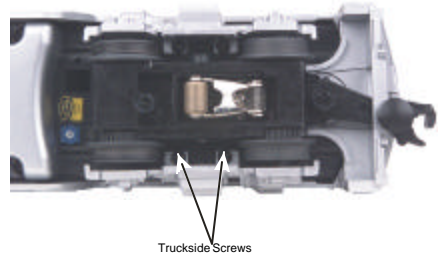

A. Remove the two Phillips screws that attach the truck sides to the truck block.

B. Remove the trucks from the chassis and the truck sides from the trucks in order to slip the new tire over the grooved drive wheel. See Fig. 4 for which screws you must remove to do this.

*Figure 4. Screws to Remove to Access the Traction Tires*

Once the truck sides have been removed:

1. Make sure the old tire has been completely removed from the groove in the drive wheel, using a razor blade or small flathead screwdriver to pry away any remains.

2. Slip the new tire onto the wheel. You may find it useful to use two small flathead screwdrivers to stretch the tire over the wheel.
3. If you twist the tire while stretching it over the wheel, you will need to remove and reinstall the tire. Otherwise your engine will wobble while operating.
4. Make sure the tire is fully seated inside the groove. Use a razor blade to trim away any excess tire that doesn't seat itself inside the groove properly.
5. Reassemble in reverse order.

One set of replacement tires is packaged with the model. Additional tires are available directly from the M.T.H. Parts Department (phone: 410-381-2580; fax: 410-423-0009; e-mail: parts@mth-railking.com; mail: 7020 Columbia Gateway Drive, Columbia MD 21046-1532).

## **Locomotive Light Bulb Replacement**

To replace the light bulb in the locomotive, follow these instructions:

Follow the cab removal instructions found in the “Lubrication and Greasing” section of this booklet. Once the body has been removed, remove the lights as shown in Fig. 5 and replace it.

You can obtain replacement bulbs directly from the M.T.H. Parts Department.

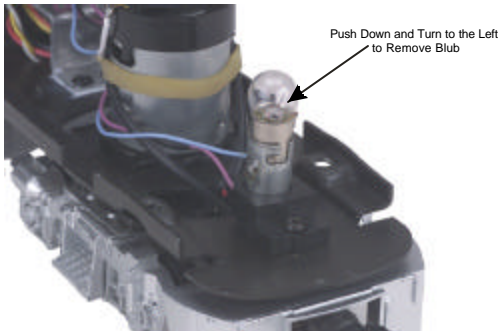

*Figure 5. Location of the headlamp in the Engine.*

# Troubleshooting Loco-Sound™ Problems

Although Loco-Sound has been designed and engineered for ease of use, you may have some questions during initial operation. The following table should answer most questions. If your problem cannot be resolved with this table, contact M.T.H. for assistance (telephone: 410-381-2580; fax: 410-423-0009; service@mth-railking.com, 7020 Columbia Gateway Drive, Columbia MD

Starting Up	Remedy
<p>When I first turn the power on, the engine will not begin to run. I have to turn the throttle off and then on again to get the engine to operate.</p>	<p>This is normal behavior. To prevent accidental high-speed start-ups, Loco-Sound is programmed to start up in neutral anytime track power has been turned off for several seconds. See the "Basic Operation" section for more details.</p>
Horn	Remedy
<p>I can't get the horn to blow when I press the whistle button.</p>	<p>You may be pressing the button too quickly. Try pressing the whistle button more slowly, taking approximately one full second to fully depress the button.</p>
Bell	Remedy
<p>I can't get the bell to ring when I press the bell button.</p>	<p>You may be pressing the button too quickly. Try pressing the bell button more slowly, taking approximately one full second to fully depress the button.</p>
Lock-out	Remedy
<p>I can't get the engine to run after I power up the transformer. It sits still with the engine sounds running.</p>	<p>The engine is locked into the neutral position. Follow the procedure in the "Lock into a Direction" section.</p>
<p>The engine won't lock into forward, neutral, or reverse.</p>	<p>Engine speed must be below 10 scale mph (approx. 10 volts or less in conventional mode).</p>

Volume	Remedy
The sounds seem distorted, especially when the whistle or bell is activated.	Loco-Sound volume is set too high. Turn the volume control knob on the bottom of the chassis counter-clockwise to reduce the volume.

## Compatibility

This engine will operate on any traditional O-31 or larger O Gauge track system, including M.T.H.'s RealTrax<sup>®</sup> or ScaleTrax<sup>™</sup> or traditional tubular track. It is also compatible with most standard AC transformers. (See page 14 for a complete list of compatible transformers and wiring instructions.)

# Transformer Compatibility and Wiring Chart

Note that many of the operational commands described in these instructions require a bell button, so if your transformer does not have its own bell button, you should consider adding one to get the full benefit of the system.

Transformer Model	Center Rail	Outside Rail	Min/Max. Voltage	Power Rating	Transformer Type
MTH Z-500	Red Terminal	Black Terminal	0-18v	50-Watt	Electronic
MTH Z-750	Red Terminal	Black Terminal	0-21v	75-Watt	Electronic
MTH Z-4000	Red Terminal	Black Terminal	0-22v	390-Watt	Electronic
Lionel 1032	U	A	5-16v	90-Watt	Standard
Lionel 1032M	U	A	5-16v	90-Watt	Standard
Lionel 1033	U	A	5-16v	90-Watt	Standard
Lionel 1043	U	A	5-16v	90-Watt	Standard
Lionel 1043M	U	A	5-16v	90-Watt	Standard
Lionel 1044	U	A	5-16v	90-Watt	Standard
Lionel 1053	U	A	8-17v	60-Watt	Standard
Lionel 1063	U	A	8-17v	60-Watt	Standard
All-Trol	Left Terminal	Right Terminal	0-24v	300-Watt	Electronic
Dallee Hostler	Left Terminal	Right Terminal			Electronic
Lionel LW	A	U	8-18v	75-Watt	Standard
Lionel KW	A or B	U	6-20v	190-Watt	Standard
Lionel MW	Outside Track Terminal	Inside Track Terminal	5-16v	50V.A.	Electronic
Lionel RS-1	Red Terminal	Black Terminal	0-18v	50V.A.	Electronic
Lionel RW	U	A	9-19v	110-Watt	Standard
Lionel SW	U	A	Unknown	130-Watt	Standard
Lionel TW	U	A	8-18v	175-Watt	Standard
Lionel ZW	A,B,C or D	U	8-20v	275-Watt	Standard
Lionel Post-War Celebration Series ZW	A,B,C or D	Common	0-20v	135/190 Watt	Electronic

\* Conventional Mode Only

## **CAUTION: Electrically Operated Product:**

**Not recommended for children under 10 years of age. M.T.H. recommends adult supervision with children ages 10 - 16. As with all electric products, precautions should be observed during handling and use to reduce the risk of electric shock.**

**WARNING:** When using electrical products, basic safety precautions should be followed including the following:

Read this manual thoroughly before using this device.

M.T.H. recommends that all users and persons supervising use examine the hobby transformer periodically for conditions that may result in the risk of fire, electric shock, or injury to persons, such as damage to the primary cord, plug blades, housing, output jacks or other parts. In the event such conditions exist, the transformer should not be used until properly repaired.

As with all electrical appliances, this product should not be left in operation when unattended

# Service & Warranty Information

## How to Get Service Under the Terms of the Limited One-Year Warranty

For warranty repair, do not return your product to the place of purchase. Instead, follow the instructions below to obtain warranty service as our dealer network is not prepared to service the product under the terms of this warranty.

1. First, write, call or FAX M.T.H. Electric Trains, 7020 Columbia Gateway Drive, Columbia, MD 21046, (Tel 410-381-2580; FAX No.: 410-423-0009; e-mail: [service@nth-Railking.com](mailto:service@nth-Railking.com)), stating when it was purchased and what seems to be the problem. You will be given a return authorization number to assure that your merchandise will be properly handled upon its receipt.

2. CAUTION: Make sure the product is packed in its original factory packaging including its foam and plastic wrapping material so as to prevent damage to the merchandise. The shipment must be prepaid and we recommend that it be insured. A cover letter including your name, address, daytime phone number, e-mail address (if available), Return Authorization number, a copy of your sales receipt and a full description of the problem must be included to facilitate the repairs. Please include the description regardless of whether you discussed the problem with one of our service technicians when contacting M.T.H. for your Return Authorization number.

3. Please make sure you have followed the instructions carefully before returning any merchandise for service.

## Limited One-Year Warranty

All M.T.H. products purchased from an Authorized M.T.H. Train Merchant are covered by this warranty.

See our website at [www.nth-railking.com](http://www.nth-railking.com) or call 1-888-640-3700 to identify an Authorized M.T.H. Train Merchant near you.

M.T.H. products are warrantied for one year from the date of purchase against defects in material or workmanship, excluding light bulbs and traction tires. We will repair or replace (at our option) the defective part without charge for the parts or labor, if the item is returned to M.T.H. Electric Trains within one year of the original date of purchase. This warranty does not cover damages caused by improper care, handling, or use. Transportation costs incurred by the customer are not covered under this warranty.

Items sent for repair must be accompanied by a return authorization number, a description of the problem, and a copy of the original sales receipt from an Authorized M.T.H. Train Merchant, which gives the date of purchase. Call 410-381-2580, fax 410-423-0009, or e-mail the Service Department at [Service@nth-railking.com](mailto:Service@nth-railking.com) to obtain a return authorization number.

This warranty gives you specific legal rights, and you may have other rights that vary from state to state.

Service Department  
M.T.H. Electric Trains  
7020 Columbia Gateway Drive  
Columbia, MD 21046-1522





# AUTHORIZED SERVICE CENTER

7020 Columbia Gateway Dr. - Columbia, MD 21046

Information: 410-381-2580 Fax: 410-381-6122

[www.mth-railking.com](http://www.mth-railking.com)

## PARTICIPATING RETAILER LIST

### ALABAMA

SOUTHERLAND STATION

HUNTSVILLE

256-533-4720

[railway@bellsouth.net](mailto:railway@bellsouth.net)

### ARIZONA

ARIZONA TRAIN DEPOT

MESA

480-833-9486

[sales@arizonatraindepot.com](mailto:sales@arizonatraindepot.com)

[www.arizonatraindepot.com/](http://www.arizonatraindepot.com/)

### CALIFORNIA

DOLLHOUSES, TRAINS & MORE

NOVATO

415-883-0388

[kbecker@cmc.net](mailto:kbecker@cmc.net)

TIN PLATE JUNCTION

OAKLAND

510-444-4780

[TOYTRAINS@email.msn.com](mailto:TOYTRAINS@email.msn.com)

### COLORADO

MIZELL TRAINS Inc

WESTMINSTER

303-429-4811

[mizelltrains@cs.com](mailto:mizelltrains@cs.com)

[www.mizelltrains.com](http://www.mizelltrains.com)

### CONNECTICUT

SHELTON RAILROAD SYSTEMS

SHELTON

203-924-8761

[adriani@clearlight.com](mailto:adriani@clearlight.com)

NEW ENGLAND HOBBY SUPPLY

MANCHESTER

860-646-0610

[bobbell@nehobby.com](mailto:bobbell@nehobby.com)

### DELAWARE

K R R B MODEL TRAINS IN C.

NEWARK

302-292-2779

[info@krrb.com](mailto:info@krrb.com)

[www.krrb.com](http://www.krrb.com)

### FLORIDA

DEPOT HOBBY SHOP

LAKE WORTH

561-585-1982

[jimmyt1982@aol.com](mailto:jimmyt1982@aol.com)

[www.depotohobbies.com](http://www.depotohobbies.com)

COLONIAL PHOTO & HOBBY

ORLANDO

407-841-1485

[trains@colonialphotoandhobby.com](mailto:trains@colonialphotoandhobby.com)

WARRICK CUSTOM HOBBIES

PLANTATION

954-370-0708

[info@warrickcustomhobbies.com](mailto:info@warrickcustomhobbies.com)

[www.warrickcustomhobbies.com](http://www.warrickcustomhobbies.com)

FRANK'S TRAINS & HOBBIES INC.

OLDSMAR

813-855-1041

[FTH@allhobbies.com](mailto:FTH@allhobbies.com)

[www.allhobbies.com](http://www.allhobbies.com)

READY TO ROLL

MIAMI

305-688-8868

[rrtrains@aol.com](mailto:rrtrains@aol.com)

[www.readytorolltrains.com](http://www.readytorolltrains.com)

### ILLINOIS

BIKE & CHOO CHOO CONNECTION

SCHAUMBURG

847-882-7728

[trainconnection@aol.com](mailto:trainconnection@aol.com)

### INDIANA

Y. O. R. K. TRAINS

MUNSTER

219-838-9999

[yorktrains@aol.com](mailto:yorktrains@aol.com)

SAMUELSON'S TRAIN SHOP

VALPARAISO

219-462-2708

### LOUISIANA

AMERICA'S TRAIN YARD

BATON ROUGE

225-926-5592

### MAINE

WHEELS, WINGS & THINGS

LUDLOW

207-532-6277

[irc44@javanet.com](mailto:irc44@javanet.com)

### MARYLAND

ENGINE HOUSE HOBBIES

GAITHERSBURG

301-590-0816

[luciececise@aol.com](mailto:luciececise@aol.com)

J & B TRAINS

HAGERSTOWN

240-420-4930

HOBBYTOWN USA

FREDERICK

301-694-7395

PURKEY'S TOY TRAINS

SYKESVILLE

410-549-6061

[wiley@oldmainline.com](mailto:wiley@oldmainline.com)

THE TRAIN ROOM

HAGERSTOWN

301-745-6681

### MASSACHUSETTS

NORTHEAST TRAINS

PEABODY

978-532-1615

[www.netrains.com](http://www.netrains.com)

### MICHIGAN

BRASSEUR ELECTRIC TRAINS INC.

SAGINAW

517-793-4753

[bob@traindoctor.com](mailto:bob@traindoctor.com)

[www.traindoctor.com](http://www.traindoctor.com)

**MISSOURI**

SWITCH STAND  
SAINT LOUIS  
314-781-4458  
r41877@earthlink.com

MARK TWAIN HOBBY CENTER  
ST. CHARLES  
636-946-2816  
webmaster@hobby1.com  
www.hobby1.com

**NEW HAMPSHIRE**

TREASUREDTOYS  
SALEM  
603-898-7224  
ttoys@treasured-toys.com  
www.treasured-toys.com

RAILROAD SPECIALTIES  
HUDSON  
603-882-5566  
crew@electric-trains.com  
www.electric-trains.com

**NEW JERSEY**

TRAINS & THINGS  
TRENTON  
609-883-8790  
trainsanthings@aol.com

GRAND CENTRAL STATION  
KEARNY  
201-955-6200  
228gene@gateway.com

HOBBYMASTERS, INC  
RED BANK  
732-842-6020  
hobbymasters@hobbymasters.com

HOLLY BEACH TRAIN DEPOT  
WILDWOOD  
609-522-2379  
larry@pro-usa.net

COAST TRAINS AND COLLECTIBLES  
WALL  
732-556-9005  
coasttrain@aol.com  
www.coastrains.com

J & B TRAINS, INC.  
MAPLE SHADE  
856-414-0092  
BASE1130@aol.com

HOBBY SHOP  
MATAWAN  
732-583-0505  
hobbysshopnj.com

ATLANTIC RAILS  
HAMMONTON  
609-567-8490  
bobcap@pics.com  
www.atlanticrails.com

COUNTRY AND STUFF  
ANDOVER  
973-786-7086  
stuff@crystal.palace.net

RIDGEFIELD HOBBY  
RIDGEFIELD  
201-943-2636

COLUMBUS TRAIN STATION  
COLUMBUS  
609-518-1800

**NEW YORK**

AURORA RAILS & HOBBIES  
EAST AURORA  
716-652-5718  
rk82141@aol.com

AMERICANASTORE  
TIVOLI  
845-757-4246  
mthdepot@valstar.net

NASSAU HOBBY CENTER, INC.  
FREEPORT  
516-378-9594  
Charlienassau@aol.com

KROSS HARDWARE  
WEST BABYLON  
631-669-3069  
1989@aol.com

CITY DEPOT, INC.  
NEW HAMPTON  
845-374-3010  
citydepot@frontiernet.net  
www.citydepot.com

**NORTH CAROLINA**

DRY BRIDGE STATION  
MOUNT AIRY  
336-786-9811  
mikek@drybridgestation.com  
www.drybridgestation.com

THE FREIGHT YARD  
SMITHFIELD  
919-934-6229  
disbissette@aol.com

TRAINS LTD.  
CHARLOTTE  
704-566-9070  
modelrrs@bellsouth.net  
www.trainsltd.com

THE ROUNDHOUSE & BACKSHOP  
CARY  
919-465-0810

**OHIO**

DIXIE UNION STATION  
MASON  
513-459-0460  
rockylane@core.net  
www.dixieunionstation.com

RICK'S TOY TRAINS  
TOLEDO  
419-478-0171

T & K HOBBY SHOP  
BRIDGEPORT  
740-633-6607  
salea@tkhobbies.com  
www.tkhobbies.com

TRAINS-N- THINGS  
CANTON  
330-499-1666  
trains@sssnet.com

PARMA HOBBY  
CLEVELAND  
216-741-6440  
info@parmahobby.com

GLEN'S TRAIN SHOP  
AKRON  
330-253-6527

E & S TRAINS  
AKRON  
330-745-0785

GRAND PACIFIC JUNCTION  
OLMSTEAD FALLS  
440-235-4777  
gpjmr@juno.com  
HUDSON TOY, TRAIN & HOBBY  
HUDSON  
330-653-2997  
ejpicke@aol.com

DAVIS ELECTRONICS  
MILFORD  
513-831-6425  
davistrains@fuse.net  
www.davistrains.com

SANDY'S HOBBY'S & COLLECTIBLES  
ELYRIA  
440-365-9999  
sandyshobb@aol.com

ERIE RAILWAY DEPOT  
TROY  
937-440-9972  
orville@gle.net

CLEARVIEW TRAIN & HOBBY  
LORAIN  
440-277-4488  
klogar@erienet.net  
www.clearviewtrainandhobby.com

PENNSYLVANIA  
FAIRCHANCE PHARMACY  
FAIRCHANCE  
724-564-7817  
mthdealer@aol.com  
www.hhs.net/fairchance

THE STATION  
NEW CUMBERLAND  
717-774-7096  
station@paonline.com  
BUSSINGER TRAINS  
AMBLER  
215-628-2366  
choochoos@icdc.com  
www.icdc.com/~btrains

CHARLEROI SWEEPER CENTER  
CHARLEROI  
724-483-3397

AMERICAN HOBBY CENTER  
ALIQUIPPA  
724-378-3930  
american@icubed.com

CRANBERRY HOBBY DEPOT  
CRANBERRY TWP  
724-776-3640  
JAdams6113@aol.com

ALLENTOWN TOY TRAIN SERVICE  
ALLENTOWN  
610-821-0740

ON THE RIGHT TRACK  
A LTOONA  
814-942-4345

JIM'S TRAIN SHOP  
HOMER CITY  
724-479-2026  
sudsy@stargate.net

YE OLDE TRAIN & CHRISTMAS  
SHOPPE  
BOYERTOWN  
610-369-0755  
www.yeoldetrain.com

TOBY TYLER'S HOBBY CENTER  
PITTSBURGH  
412-653-5030  
tobytyler111@cs.com

BUSTLETON TRAIN SHOP  
PHILADELPHIA  
215-698-7266

CHESTNUT TOYBOX  
PHILADELPHIA  
215-545-0455  
chestnuttoy@earthlink.net

THE CABOOSE  
LEHIGHTON  
570-386-5352  
www.thecaboosehobbies.com  
victen@ptd.net

**SOUTH CAROLINA**  
EMERALD TRAIN & HOBBY  
GREENWOOD  
864-223-2247

**TENNESSEE**  
MODEL RAILROAD & HOBBY SHOP  
MEMPHIS  
901-384-6500  
mrhs99@earthlink.net  
www.modelrailroadandhobby.com

**TEXAS**  
HOBBY TIME  
AMARILLO  
806-352-9660  
don.l.harris.@hobby-time.com

**VIRGINIA**  
TRAIN DEPOT  
MANASSAS  
703-335-2216

NORGE STATION  
WILLIAMSBURG  
757-564-7623  
norgetrains@cs.com

NUTBUSH EXPRESS  
VICTORIA  
804-696-1902  
thenutbushexp@meckcom.net

TOY TRAIN CENTER  
RICHMOND  
804-288-4475

T S G HOBBIES  
WARRENTON  
540-347-9212  
tripl@mnsinc.com  
www.mnsinc.com/tripl/tsg.htm

CHESTERFIELD HOBBIES  
MIDLOTHIAN  
804-379-9091  
chsthobb@erols.com  
www.chesterfieldhobbies.com

DAVIS HOBBY SUPPLIES  
PORTSMOUTH  
757-397-1983  
ralph@davishobby.com  
www.davishobby.com

LOCUST GROVE TRAINS  
LOCUST GROVE  
540-854-8955  
lgrains@aol.com  
www.locustgrovetrains.com

**WEST VIRGINIA**  
PATRICK'S TRAINS  
WHEELING  
304-232-0714  
trains@patstrains.com  
www.patstrains.com

**WISCONSIN**  
SOMMERFELD'S TRAINS  
BUTLER  
262-783-7797  
questions@sommerfelds.com  
www.sommerfelds.com

G B T V & TRAINS  
GREEN BAY  
920-496-9697  
rrtycoon@netnet.net

GRAMPA'S TRAIN SHOP  
RICE LAKE  
715-234-2996  
grampastrains@yaho.com

THE TRAIN STORE  
WAUKESHA  
262-650-6675

HOBBY OUTLET  
FOND DU LAC  
920-924-3770  
hobby\_outlet@hotmail.com

**CANADA**  
**ONTARIO**  
CREDIT VALLEY RAILWAY COMPANY  
STREETSVILLE  
905-826-1306  
CVRCO@globalseve.net  
www.cvrco.com

TOY TRAIN WORKSHOP  
CUMBERLAND  
613-833-3125  
info@toytrainworkshop.com  
www.toytrainworkshop.com

THE TRAIN ROOM  
FERGUS  
519-787-3280

