

RAIL KING
By MTH Electric Trains

M.T.H.

ELECTRIC TRAINS, INC.

7020 Columbia Gateway Drive
Columbia, MD 21046-1532

www.mth-railking.com



Now the passengers on your layout can act as realistic as your trains. When the RailKing® Operating Passenger Platform is connected to the activation button or to an ITAD, its passengers "board" their train when it stops at the station, leaving behind empty platforms when the train departs. The secret to the empty platforms is a design that hides the passengers under the roof of the platform, so that they appear to have boarded the train.

It will be easy to surprise friends and family with the Operating Passenger Platform when you follow the directions inside.

Operating
Passenger Platform

WIRING INSTRUCTIONS

The RailKing Operating Passenger Platform is made up of two components: the platform and the switch. Before you place the platform on the layout, you must wire it to the switch and power source. There are two ways you can do this: hook the platform to the switch or hook the platform to an Infrared Track Activation Device (ITAD sold separately). The Operating Passenger Platform needs 14-16 volts to operate.

Note: This unit is equipped with a safety device to prevent overheating. If the platform is operated at less than 14 volts, the swing can become stuck in the in between cycle, causing the coil to overheat. The safety device will shut the unit down to prevent this. If this happens, turn off power to the operating passenger platform for 10 minutes. Then the platform will be ready to operate again at 14-16 volts.

Option 1

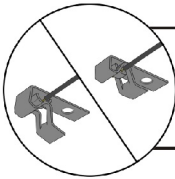

Strip Z-wire cable harness insulation to reveal 1/4" of bare wire.

From 4 Pin Connector

- A Connect Green wire to terminal A
- B Connect Blue wire to terminal B
- C Connect White wire to terminal C
- D Connect Yellow wire to terminal D

From 2 Pin Connector

- Connect Black wire to AC Ground
- Connect Red wire to AC Hot

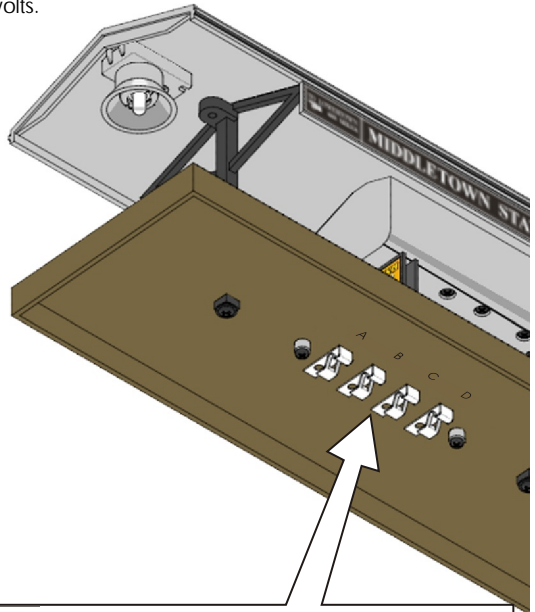

Plug 4-Pin Connector into Switch



Plug 2-Pin Connector into Switch

A B C D
AC Ground AC Hot

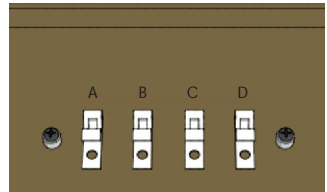
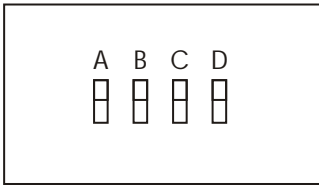

Fig 1. Wiring Diagram

To operate when the platform is connected to the switch: Simply flip the switch whenever you want to move the people. The red light indicates that the people are down, waiting to board the train, and the green light indicates that the people are tucked under the roof, not visible on the

Option 2

Connecting the platform to an ITAD: Connect the wires from under the platform to the track and ITAD as shown below. If you choose this option, you will not use the included switch.



Underside of Passenger Platform

- A** Outer Rail (Transformer AC GROUND)
- B** ITAD - N.O. (Normally OPEN)
- C** ITAD - N.C. (Normally CLOSED)
- D** Center Rail (Transformer AC HOT)

To operate when the platform is connected to an ITAD: Be sure the ITAD is set to track power and in a location where the train will activate it when the people should board. You should also set the ITAD for a 10-15 second delay after the train has moved past it, so that people viewing the layout have time to see that the people are gone after the train pulls away. You may want to adjust the sensitivity of the ITAD to work best with the distance of the train and operators on your layout.

M.T.H. suggests the layout shown in the diagram below as one option when using an ITAD:

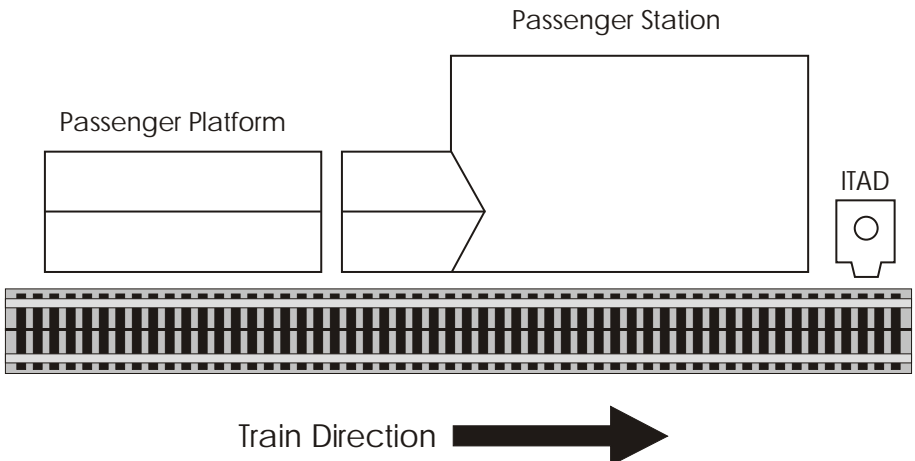

Changing the Light Bulbs: When the lights under the roof of the platform burn out, replace them by popping the old one out and the new one back in like Christmas tree lights. You can obtain replacement bulbs directly from the M.T.H. Parts Department (phone: 410-381-2580; e-mail: parts@meth-railking.com; mail: 7020 Columbia Gateway Drive, Columbia MD 21046-1532).



Passenger Station Platform

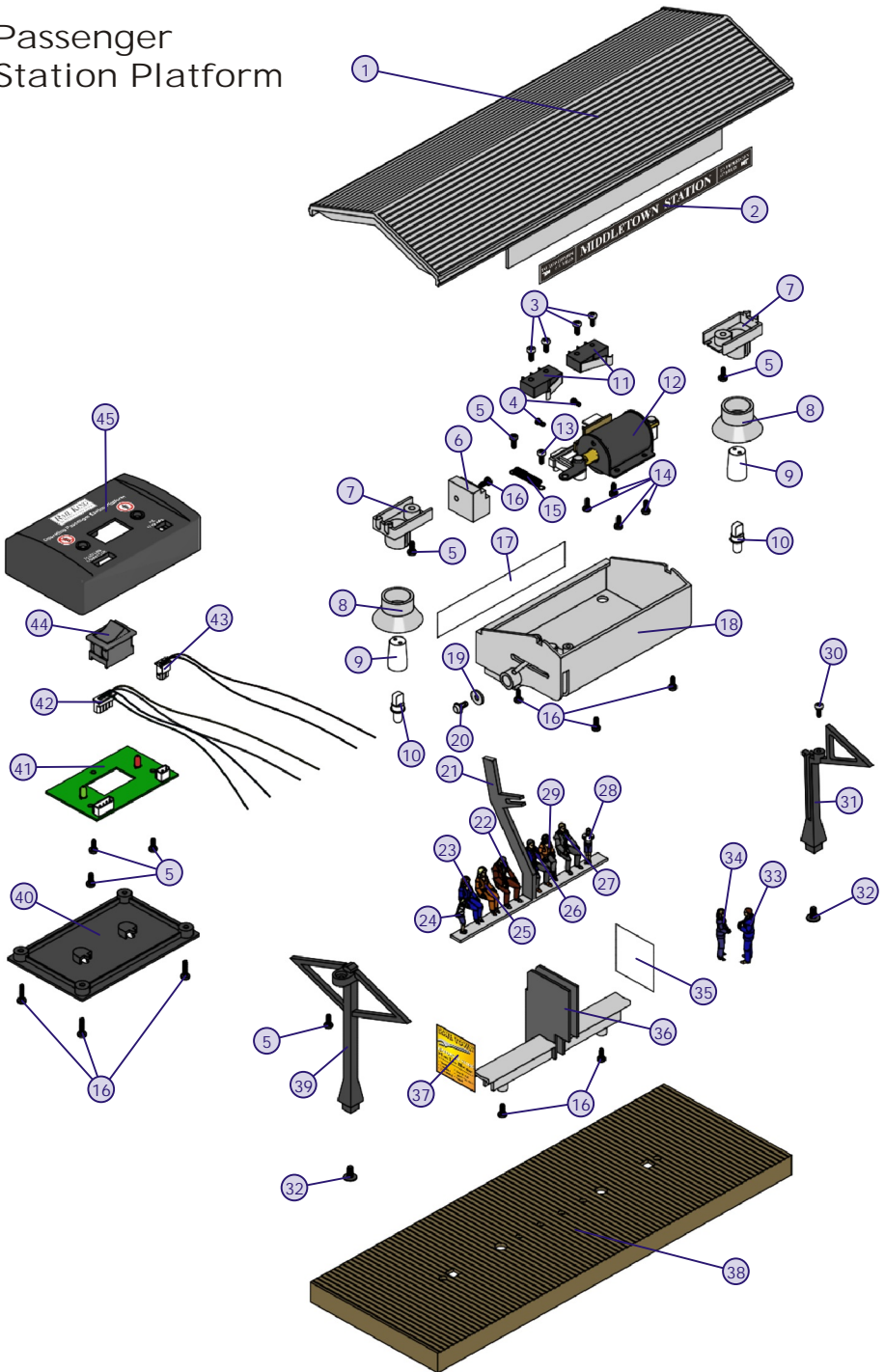

Passenger Station Platform

Parts

Name and Number	Part #	Name and Number	Part #
1.) Roof	HH-5200043	37.) Sign	HH-5200063
2.) Sign { Middletown Station } { To Lowertown 605 Miles & To Uppertown 337 Miles }	HH-5200044	{ MTH Railways }	
3.) Screw { M2.3X10.0mm } { roundhead } { plastic cutting threads }	IA-0000283	38.) Platform base	HH-5200064
4.) Screw { M2X3.0mm } { roundhead }	IA-0000018	39.) Roof support	HH-5200065
5.) Screw { M2.6X6.0mm } { roundhead } { plastic cutting threads }	IA-0000206	40.) Control box bottom	HH-5200066
6.) Weight	II-5200001	41.) PCB control board	BB-0000024
7.) Light holder	HH-5200045	{ w/ red & green L.E.D.s }	
8.) Light shade	HH-5200046	42.) Wire harness { 4 pin plug } { yellow, white, blue & green wires }	BC-0000043
9.) Light socket { w/ wires }	CH-0000031	43.) Wire harness { 2 pin plug } { red & black wires }	BC-0000044
10.) Bulb { 12V } { grain of wheat }	CG-0000017	44.) Switch	BB-0000025
11.) Switch { micro }	BB-0000021	45.) Control box	HH-5200067
12.) Solenoid { complete }	BE-0000053		
13.) Screw { M2.5X4.0mm } { roundhead }	IA-0000023	*Requires Exchange	
14.) Screw { M2.5X5.0mm } { roundhead }	IA-0000044		
15.) Spring { 3.6X20.0mm } { 2 eyelets on each end } { 0.3mm thick wire }	IE-0000049		
16.) Screw { M2.6X8.0mm } { roundhead } { plastic cutting threads }	IA-0000272		
17.) Sign { Middletown Station } { MTH Transit, clock face }	HH-5200047		
18.) Solenoid cover { complete }	HH-5200048		
19.) Washer { 3.2X9.8X0.7mm }	ID-0000083		
20.) Screw { M2.6X8.0mm } { washer head } { plastic cutting threads }	IA-0000281		
21.) Lever { for people }	HH-5200049		
22.) Sitting man { dark gray w/ hat }	HH-5200050		
23.) Sitting woman { black, brown & white w/ red hat }	HH-5200051		
24.) Standing girl { light blue & white }	HH-5200052		
25.) Sitting woman { blue }	HH-5200053		
26.) Sitting man { dark blue & white }	HH-5200054		
27.) Sitting man { brown }	HH-5200055		
28.) Standing boy { brown & gray }	HH-5200056		
29.) Sitting woman { green }	HH-5200057		
30.) Screw { M2.5X6.0mm } { roundhead }	IA-0000185		
31.) Roof support { half }	HH-5200058		
32.) Screw { M3X5.0mm } { washer head }	IA-0000216		
33.) Standing man { black }	HH-5200059		
34.) Standing woman { red & black }	HH-5200060		
35.) Sign { Rail Town Hardware Store }	HH-5200061		
36.) Bench seats & sign holder	HH-5200062		

CAUTION: ELECTRICALLY OPERATED PRODUCT:

Not recommended for children under 8 years of age without adult supervision. As with all electric products, precautions should be observed during handling and use to reduce the risk of electric shock.

WARNING: When using electrical products, basic safety precautions should be followed including the following:

- Read this manual thoroughly before using this device.
- M.T.H. recommends that all users and persons supervising use examine the unit periodically for conditions that may result in the risk of fire, electric shock, or injury to persons, such as damage to the primary cord, plug blades, housing, output jacks or other parts. In the event such conditions exist, the unit should not be used until properly repaired.
- This unit is intended for indoor use. Do not use if water is present. Serious injury or fatality may result.
- Do not operate with damaged wires or clips.
- Do not use this unit for other than its intended purpose. This unit was designed to operate with any AC or DC output toy train transformer. See the transformer's operating instructions for more operating and safety information.

SERVICE & WARRANTY INFORMATION

How to Get Service Under the Terms of the Limited One-Year Warranty

For warranty repair, do not return your product to the place of purchase. Instead, follow the instructions below to obtain warranty service as our dealer network is not prepared to service the product under the terms of this warranty.

- First, write, call, e-mail, or FAX M.T.H. Electric Trains ®, 7020 Columbia Gateway Drive, Columbia, MD 21046 (Tel.: 410.381.2580; e-mail: service@mth-railking.com; FAX: 410.381.6122), stating when it was purchased and what seems to be the problem. You will be given a return authorization number to assure that your merchandise will be properly handled upon its receipt.
- **CAUTION: Make sure the product in its original factory packaging including its foam and plastic wrapping material so as to prevent damage to the merchandise. The shipment must be prepaid and we recommend that it be insured.** A cover letter including your name, address, daytime telephone number, e-mail address (if available), Return Authorization number, a copy of your sales receipt, and a full description of the problem must be included to facilitate the repairs. Please include the description regardless of whether you discussed the problem with one of our service technicians when contacting M.T.H. ® for your ReturnAuthorization Number.
- **Please make sure you have followed the instructions carefully before returning any merchandise for service.**

Limited One-Year Warranty

All M.T.H. ® products purchased from an Authorized M.T.H. Train Merchant are covered by this warranty.

See our web site at www.mth-railking.com or call 1.888.640.3700 to identify an Authorized M.T.H. Train Merchant near you.

M.T.H. products are warrantied for one year from the date of purchase against defects in material or workmanship, excluding light bulbs and traction tires. We will repair or replace (at our option) the defective part without charge for the parts or labor, if the item is returned to M.T.H. Electric Trains ® within one year of the original date of purchase. This warranty does not cover damages caused by improper care, handling, or use. Transportation costs incurred by the customer are not covered under this warranty.

Items sent for repair must be accompanied by a return authorization number, a description of the problem, and a **copy of the original sales receipt from an Authorized M.T.H. Train Merchant**, which gives the date of purchase. Call 410.381.2580, fax 410.423.0009, or e-mail the Service Department at service@mth-railking.com to obtain a return authorization number.

This warranty gives you specific legal rights, and you may have other rights that vary from state to state.

Service Department
M.T.H. Electric Trains ®
7020 Columbia Gateway Drive
Columbia, MD 21046-1532

